

# HYBRID STEPPING MOTOR

specifications:

PHASE	STEP ANGLE	RATED VOLTAGE	CURRENT /PHASE	RESISTANCE /PHASE	INDUCTANCE /PHASE	HOLDING TORQUE	ROTOR INERTIA	DETENT TORQUE	WEIGHT
	DEG/STEP	V	A	ohms	mH	N.cm	gcm <sup>2</sup>	kg.cm	Kg
4	1.8	7.4	1.0	7.4	10	90	300	0.4	0.7

Wiring Diagram:

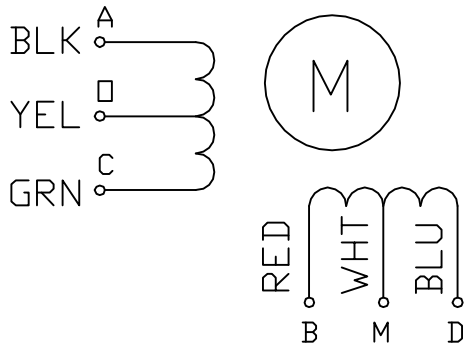

Rotation:

CW DIRECTION	STEP	A	C	B	D	O	M
↓	1	+		+		+	+
	2		+	+		+	+
	3			+		+	+
	4	+				+	+
	1	+		+		+	+

CW SEE FROM THE FLANGE SIDE

Dimension:

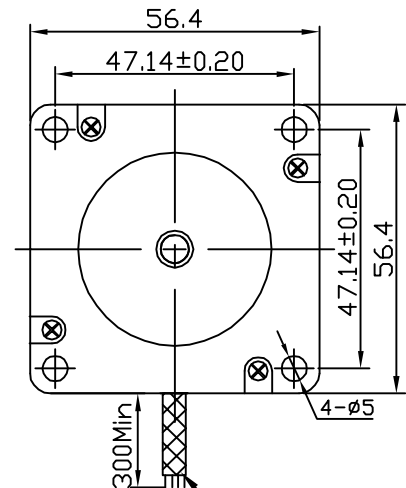
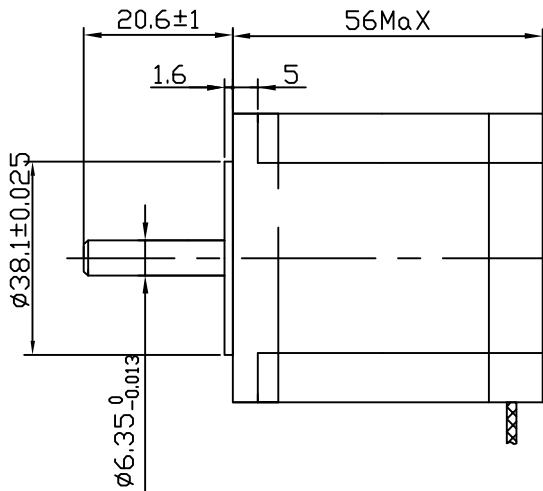

AWG22# UL1430

REV	ECN NO.	DESCRIPTION	DRN	APP'D	DATE	DESIGN	DATE	P/N.
UNLESS OTHERWISE SPECIFIED TOLERANCES: DECIMALS:      ANGULAR: .x      ±0.5      ±0°30' .xx      ±0.25 .xxx      ±0.1 UNIT: mm DO NOT SCALE DRAWING						CHECK		TITLE
						APPD		Specifications
MATERIAL  THIRD ANGLE PROJECTION						SCALE		USED ON
						SHEET OF		FL57STH56-1006A
						FULLING MOTOR		DWG NO.
								FX3.162. SS
								REV