

WEBSITE PHOTOS

⚠ This dwg is for reference only, Actual dwg should be based on formal engineering dwg issued by Kang Yang.

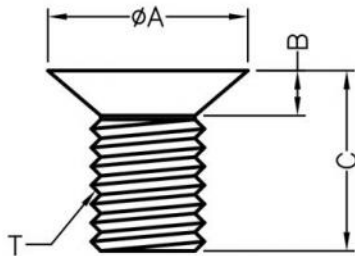
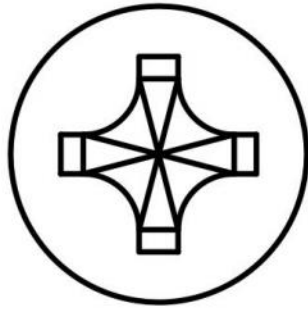

| | | | |
|-----|-----|------|---------|
| A | B | C | T |
| 5.6 | 1.6 | 14.0 | M3X0.5P |

| | |
|---|--------|
| T | THREAD |
|---|--------|

康揚企業股份有限公司
 KANG YANG HARDWARE ENTERPRISE CO., LTD.
康揚塑膠(東莞)有限公司
 KANG YANG PLASTIC(DONG GUAN)CO.,LTD.
 ISO 9001
 ISO 14001
 QC 080000
康哲電腦配件(吳江)有限公司
 KANG CHE COMPUTER COMPONENTS(WUJIANG) CO.,LTD.

| | | | | |
|--------------------|-------|--------|------------|--|
| PART NUMBER | | M3-14F | SPEC. DWG. | |
| TITLE | | | | |
| SCREW | | | | |
| MATERIAL | | | COLOR | |
| NYLON 66(UL) 94V-0 | | | BLACK | |
| SIZE | SCALE | UNIT | CHECK | |
| A4 | 2:1 | mm | Z.C | |

| PART NO | A | B | C | T | |
|---------|------|-----|------|---------|--|
| M3-5F | 5.3 | 1.2 | 4.8 | M3X0.5P | [1] NYLON 66(UL)/PC(UL), Flame class: 94V-0/94V-2, Color: BLACK/NATURAL. |
| M3-6F | 5.6 | 1.6 | 6.0 | M3X0.5P | [1] NYLON 66(UL)/PC(UL), Flame class: 94V-0/94V-2, Color: BLACK/NATURAL. |
| M3-8F | 5.6 | 1.6 | 8.0 | M3X0.5P | [1] NYLON 66(UL)/PC(UL), Flame class: 94V-0/94V-2, Color: BLACK/NATURAL. |
| M3-10F | 5.6 | 1.6 | 10.0 | M3X0.5P | [1] NYLON 66(UL)/PC(UL), Flame class: 94V-0/94V-2, Color: BLACK/NATURAL. |
| M3-12F | 5.6 | 1.6 | 12.0 | M3X0.5P | [1] NYLON 66(UL)/PC(UL), Flame class: 94V-0/94V-2, Color: BLACK/NATURAL. |
| M4-8F | 7.6 | 2.0 | 8.0 | M4X0.7P | [1] NYLON 66(UL)/PC(UL), Flame class: 94V-0/94V-2, Color: BLACK/NATURAL. |
| M4-10F | 7.6 | 2.0 | 10.0 | M4X0.7P | [1] NYLON 66(UL)/PC(UL), Flame class: 94V-0/94V-2, Color: BLACK/NATURAL. |
| M4-12F | 7.6 | 2.0 | 12.0 | M4X0.7P | [1] NYLON 66(UL)/PC(UL), Flame class: 94V-0/94V-2, Color: BLACK/NATURAL. |
| M4-14F | 7.6 | 2.0 | 14.0 | M4X0.7P | [1] NYLON 66(UL)/PC(UL), Flame class: 94V-0/94V-2, Color: BLACK/NATURAL. |
| M4-16F | 7.6 | 2.0 | 16.0 | M4X0.7P | [1] NYLON 66(UL)/PC(UL), Flame class: 94V-0/94V-2, Color: BLACK/NATURAL. |
| M4-18F | 7.65 | 2.7 | 18.0 | M4X0.7P | [1] NYLON 66(UL)/PC(UL), Flame class: 94V-0/94V-2, Color: BLACK/NATURAL. |
| M5-15F | 9.1 | 9.1 | 14.8 | M5X0.8P | [1] NYLON 66(UL)/PC(UL), Flame class: 94V-0/94V-2, Color: BLACK/NATURAL. |
| M3-4.2F | 6.0 | 1.7 | 4.2 | M3X0.5P | [1] NYLON 66(UL)/PC(UL), Flame class: 94V-0/94V-2, Color: BLACK/NATURAL. |
| M3-5.3F | 5.3 | 1.6 | 5.0 | M3X0.5P | [1] NYLON 66(UL)/PC(UL), Flame class: 94V-0/94V-2, Color: BLACK/NATURAL. |

