

三兴达微型电机有限公司

样品承认书

客 户：万宝刚



电机型号：SRE-260W-19100-38

样品编号：80181/A081128-3

用 途：RPC18TS19100U38-4.5-00

本司签章：

日期：2008年11月28日

检 查	核 对	承 认
		

客户承认签章：

检 查	核 对	承 认

版次: A

DIRECTION OF ROTATION

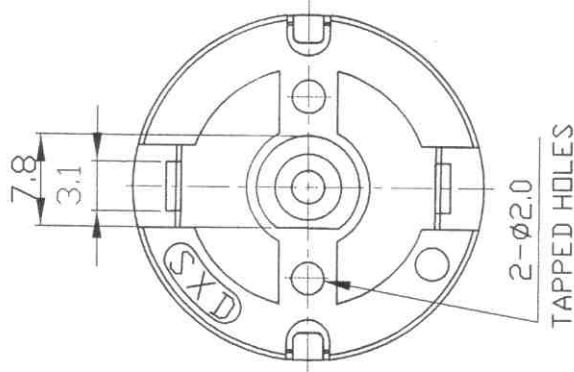
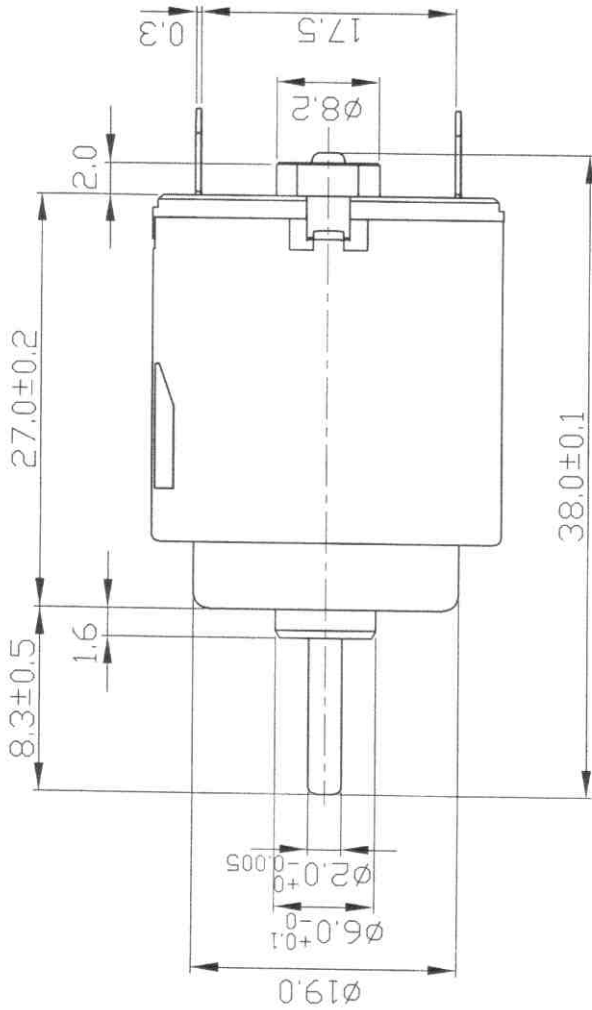
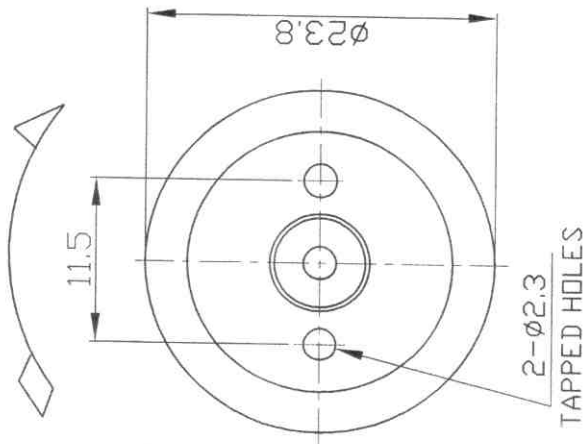

未注公差		圆角半径和倒角高度	
0~6	6~30	0~3	3~6
± 0.06	± 0.1	± 0.2	± 0.5
			± 0.8

说明:

1. 马达胶盖小圆圈处端子接正极, 电机转向为CW.
2. 额定电压: 4.5V.
3. 样品编号: A081128-3.

TITLE: 外形图

MUSTER NO:

SRE-260W-19100-38

A4



DRAWER:

CHECKER:

APPROVER:

DO NOT SCALE THE DAWING

DRAWING NO.:



SAN XING DA
ELECTRIC MFG. CO., LTD.

共5页 第5页



三兴达微型电机有限公司

SAN XING DA ELECTRIC MFG CO., LTD.

Graph drawing

Sample No: 80181/A081128-3

Customer: 万宝刚

Date: 2008-11-28

Model: SRE-260W-19100-38

----- Efficiency

----- Power output

η	P	I	N
78	4.26	3.84	15000
52	2.84	2.56	10000
26	1.42	1.28	5000
0	0	0	0

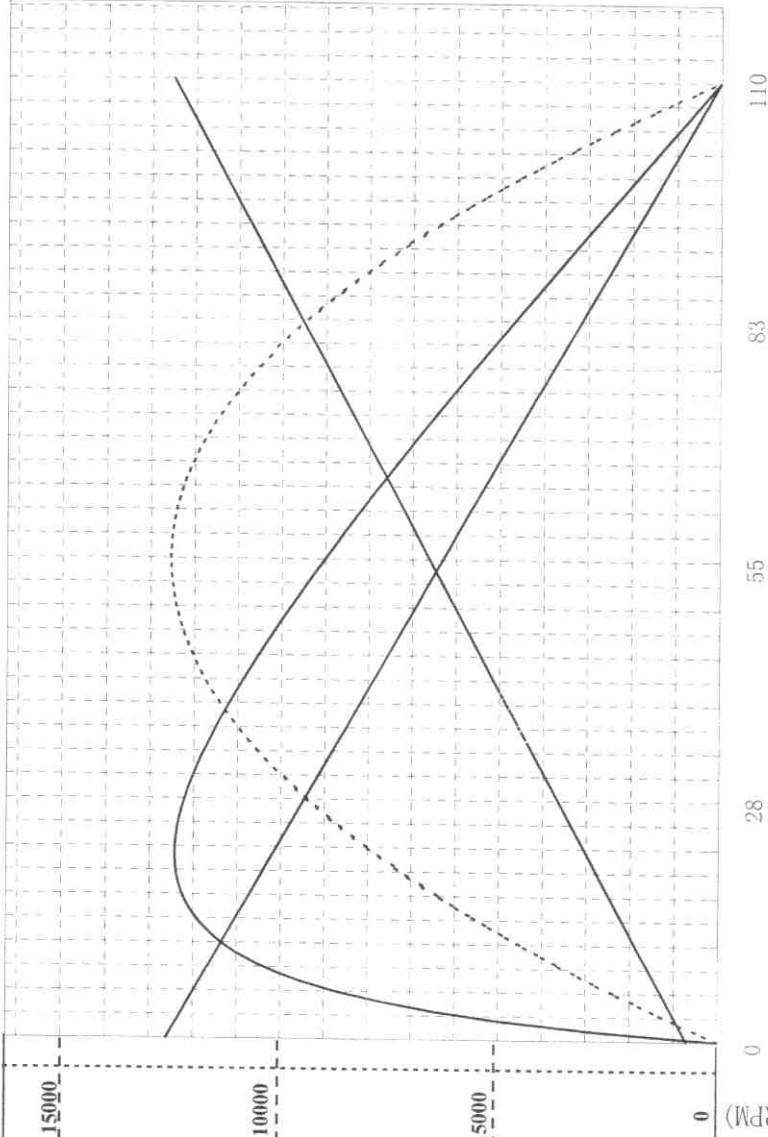

(NOTE: 1mN-m = 10.2g-cm)

共5页 第4页

NOTE: Performance (in an ambient temperature of 25-30°C)
 Motor tested rapidly to prevent significant temperature rise.

Constant voltage: 4.5 Volts

Direction: CW

At No Load

Speed: 12600 rpm

Current: 0.180 A

At stall (Extrapolated)

Torque: 110.0 g-cm

Current: 3.20 A

At maximum efficiency

Efficiency: 64.5 %

Torque: 20.9 g-cm

Speed: 10206 rpm

Current: 0.75 A

Output: 2.19 W

At maximum Power output

Output: 3.56 W

Torque: 55.0 g-cm

Speed: 6300 rpm

Current: 1.69 A

Issued by QA Reliability Testing Center

COMPUTER PRINT-OUT

NOMINAL MOTOR CURVES

Performance and characteristics are measured based on limited motor samples only

Prepared by: [Signature]

Checked by: [Signature] Approved by: [Signature]

Date: 2008.11.29

