

# 26mm ROTARY SWITCH

MODEL                      Outline Drawing                      UNIT:mm

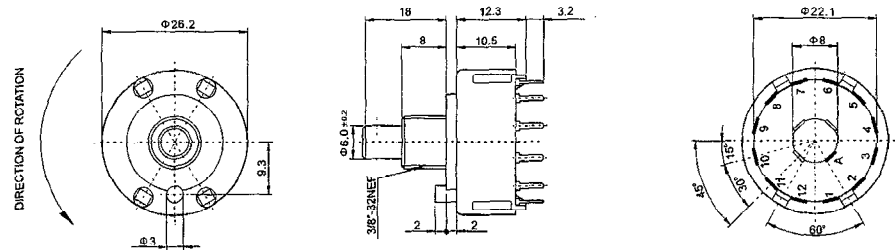
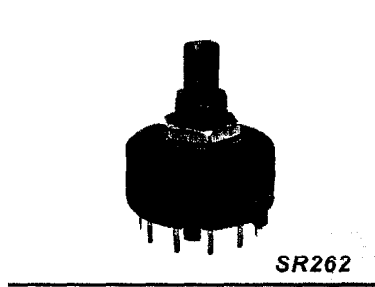
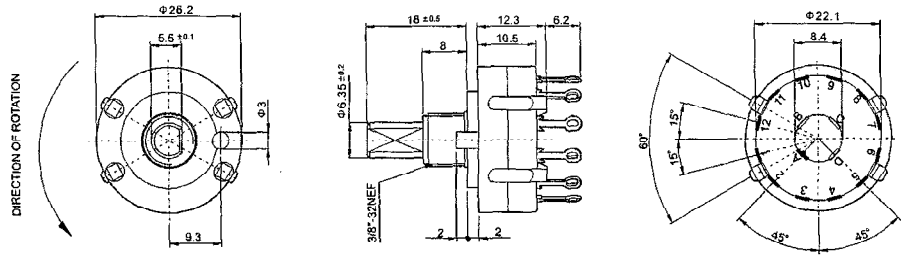
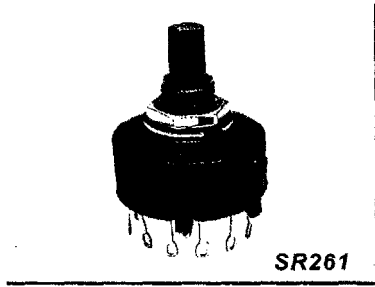

Function Similar to SR261

**TYPE OF SHAFT**

**F-TYPE**

**R-TYPE**

**FA-TYPE**

**RA-TYPE**

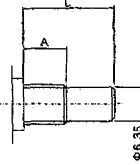
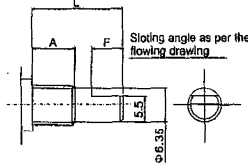
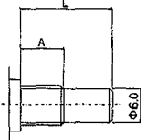
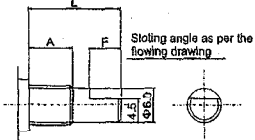

A: 8.0m/m(standard)

	13	15	18	21	29	38
F	5	7	10	13	21	30
L	13	15	18	21	29	38

	13	18	21	29	38
L	13	18	21	29	38

**TYPE OF TERMINAL**

**WIRING TYPE**

**P.C.B TYPE**

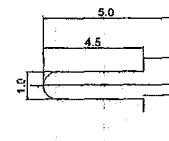
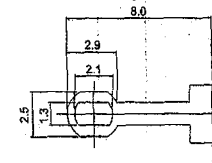

SR261/SR262 SPECIFICATION (SR261=SOLDERING TERMINAL, SR262=PCB TERMINAL.)

L=15,18,21,29,38

ORDER NO.	SW.FUNCTION	ORDER NO.	SW.FUNCTION
SR261 -1-2	SP 2 POS.	SR261 -2-2	DP 2 POS.
SR261 -1-3	SP 3 POS.	SR261 -2-3	DP 3 POS.
SR261 -1-4	SP 4 POS.	SR261 -2-4	DP 4 POS.
SR261 -1-5	SP 5 POS.	SR261 -2-5	DP 5 POS.
SR261 -1-6	SP 6 POS.	SR261 -2-6	DP 6 POS.
SR261 -1-7	SP 7 POS.	SR261 -3-2	3P 2 POS.
SR261 -1-8	SP 8 POS.	SR261 -3-3	3P 3 POS.
SR261 -1-9	SP 9 POS.	SR261 -3-4	3P 4 POS.
SR261 -1-10	SP 10 POS.	SR261 -4-2	4P 2 POS.
SR261 -1-11	SP 11 POS.	SR261 -4-3	4P 3 POS.
SR261 -1-12	Sp 12 POS.		

**SPECIFICATIONS**

RATING	AC 125V 0.3A
CONTACT RESISTANCE	25m $\Omega$ Max
INSULATION RESISTANCE	DC500V-100m $\Omega$ Min
WITHSTAND VOLTAGE	AC500V-1Minute
ROTATION TORQUE	1 $\pm$ 0.5kg/cm