

DIMENSIONS

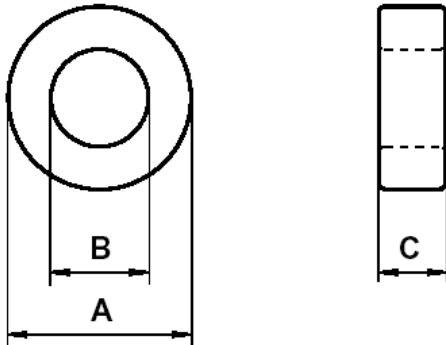

(mm)	Uncoated Nominal:	Min:	Max:
O.D. (A)	9.53	9.28	9.78
I.D. (B)	4.75	4.49	5.01
Ht. (C)	4.78	4.65	4.91

Eff. Parameters		
A_e mm ²	l_e mm	V_e mm ³
10.9	20.7	227

INDUCTANCE

A_L value (nH/T ²)	Test conditions	
599 ± 25%	10 kHz	0.5 mT (For N = 5, use 1.08 mA), 25°C

ELECTRICAL LOSSES

$\tan \delta / \mu_i$ max	$\tan \delta / \mu_i$ Typ	Test conditions	
$\leq 50 \cdot 10^{-6}$	$\leq 25 \cdot 10^{-6}$	300 kHz	0.5 mT, 25°C
$\leq 200 \cdot 10^{-6}$	$\leq 100 \cdot 10^{-6}$	1000 kHz	

TEMPERATURE FACTOR

α_F	Test conditions
$2.0 \cdot 10^{-6}$ to $-5.0 \cdot 10^{-6}$ /°C	+20°C to +40°C
$2.0 \cdot 10^{-6}$ to $-2.0 \cdot 10^{-6}$ /°C	+40°C to +70°C

COATING

Uncoated.
