

HT Heavy Duty Lugs

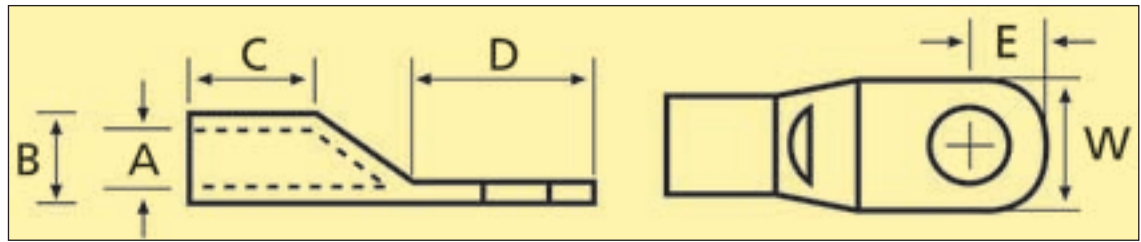

Technical Table

Cable Size (mm ²)	Stud (mm)	Code	Dimensions (mm)						
			Barrel				Spade		
			A ID	B OD	t Thickness	C Length	D Length	E Hole to End	W Width
1.5	3	HT13	1.9	3.8	0.95	7	9	5	7
	4	HT14	↓	↓	↓	↓	12	↓	7
	5	HT15	↓	↓	↓	↓	12	↓	8
	6	HT16	↓	↓	↓	↓	13	6	9
2.5	3	HT23	2.4	4.2	0.90	8	9	5	7
	4	HT24	↓	↓	↓	↓	12	↓	7
	5	HT25	↓	↓	↓	↓	12	↓	9
	6	HT26	↓	↓	↓	↓	13	6	10
4	8	HT28	↓	↓	↓	↓	15	8	12
	3	HT43	2.8	4.7	0.95	8	9	5	7
	4	HT44	↓	↓	↓	↓	12	↓	7
	5	HT45	↓	↓	↓	↓	12	↓	9
6	6	HT46	↓	↓	↓	↓	13	6	10
	8	HT48	↓	↓	↓	↓	17	7	13
	10	HT410	↓	↓	↓	11	19	8	14
	4	HT64	3.4	5.3	0.95	9	12	5	8
6	5	HT65	↓	↓	↓	↓	12	5	9
	6	HT66	↓	↓	↓	↓	13	6	10
	8	HT68	↓	↓	↓	↓	17	7	13
	10	HT610	↓	↓	↓	11	20	8	15
10	5	HT105	4.4	6.3	0.95	11	12	5	9
	6	HT106	↓	↓	↓	↓	13	6	10
	8	HT108	↓	↓	↓	↓	17	8	13
	10	HT1010	↓	↓	↓	↓	19	8	15
16	12	HT1012	↓	↓	↓	12	20	10	19
	5	HT165	5.5	7.6	1.05	12	13	6	11
	6	HT166	↓	↓	↓	↓	13	6	11
	8	HT168	↓	↓	↓	↓	18	8	13
25	10	HT1610	↓	↓	↓	↓	20	8	15
	12	HT1612	↓	↓	↓	↓	25	11	18
	16	HT1616	↓	↓	↓	↓	27	13	24
	6	HT256	6.9	9.0	1.05	15	16	6	14
35	8	HT258	↓	↓	↓	↓	17	8	14
	10	HT2510	↓	↓	↓	↓	18	8	16
	12	HT2512	↓	↓	↓	↓	21	11	18
	16	HT2516	↓	↓	↓	↓	27	13	24
50	6	HT356	8.2	10.7	1.25	15	18	8	16
	8	HT358	↓	↓	↓	↓	18	9	↓
	10	HT3510	↓	↓	↓	↓	19	9	↓
	12	HT3512	↓	↓	↓	↓	22	10	18
	16	HT3516	↓	↓	↓	16	30	13	24
	6	HT506	10.0	12.8	1.40	16	18	8	18
70	8	HT508	↓	↓	↓	↓	18	9	18
	10	HT5010	↓	↓	↓	↓	24	10	20
	12	HT5012	↓	↓	↓	↓	24	10	20
	14	HT5014	↓	↓	↓	↓	30	13	26
	16	HT5016	↓	↓	↓	↓	↓	↓	↓
	20	HT5020	↓	↓	↓	↓	↓	↓	↓
70	8	HT708	11.7	15.0	1.65	21	20	10	21
	10	HT7010	↓	↓	↓	↓	26	11	22
	12	HT7012	↓	↓	↓	↓	28	12	22
	16	HT7016	↓	↓	↓	22	32	14	28
	20	HT7020	↓	↓	↓	22	34	15	30