

75pcs of gear can match each other, all combined into gears, these gears are suitable for shaft Containing worm, straight teeth, shaft gear, the tooth crown, the double reduction gear DIY science and small production, product design, mechanical model

PVC-GEAR-1.6 / 170207

Description:

Material:plastic

Pitch = 1.5mm.

Type:Spur Gears,Pinion Gears, Double Gear, Crown Gear, Rack strips, Pulley & Belts

Quantity: 75pcs

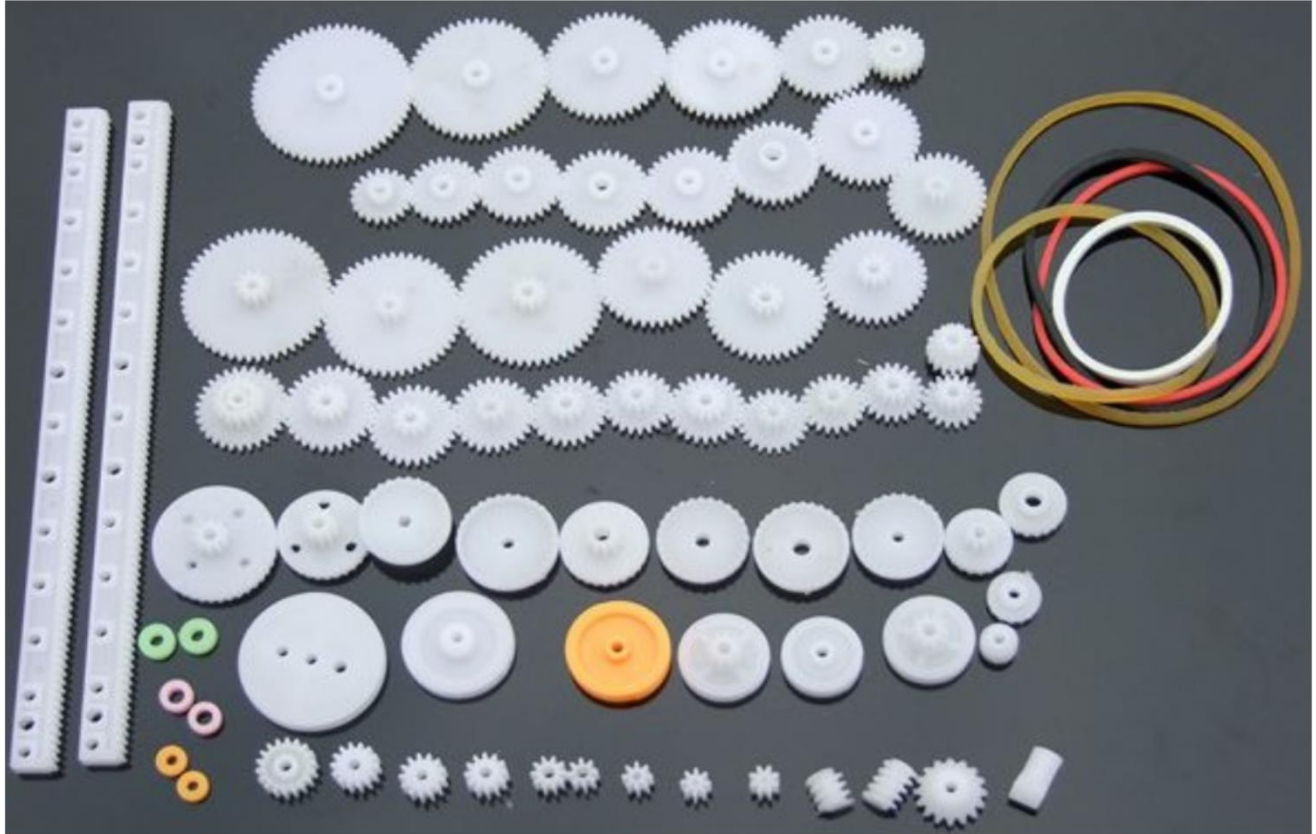

Pinion

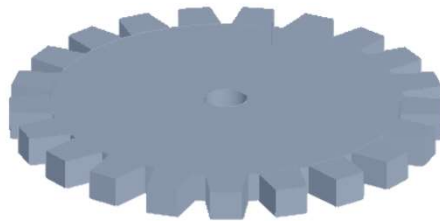

Spur

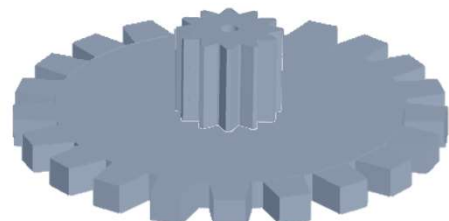

Double Spur



Bevel



Crown



Worm

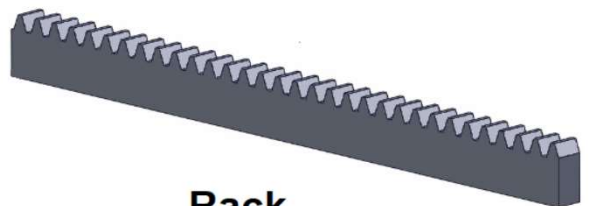

Rack

75pcs Plastic Gear Set Sizes

QTY	Type	Pitch	thickness	Hole	Dia.	Length
1	8 teeth Pinion Gear	1.6	5.0	0.8	4.9	
1	8 teeth Pinion Gear	1.6	5.0	1.0	4.9	
1	8 teeth Pinion Gear	1.6	5.0	1.5	4.9	
1	8 teeth Pinion Gear	1.6	5.0	2.0	4.9	
2	10 teeth Pinion Gear	1.6	5.0	2.0	5.9	
1	12 teeth Pinion Gear	1.6	5.0	2.0	7.0	
1	13 teeth Pinion Gear	1.6	5.0	2.0	7.5	
1	14 teeth Pinion Gear	1.6	5.0	2.0	7.8	
1	18 teeth Pinion Gear	1.6	5.0	2.0	9.8	
1	Worm Gear	1.6		2.0	6.0	6.0
1	Worm Gear	1.6		2.0	6.0	8.0
1	15 teeth Crown Gear	1.6	2.5	2.0	8.6	
2	20 teeth Crown Gear	1.6	3.0	3.0	11.0	
1	28 teeth Crown Gear	1.6	2.5	2.0	14.9	
2	28 teeth Crown Gear	1.6	2.5	2.5	14.9	
1	30 teeth Crown Gear	1.6	3.0	3.0	16.1	
1	32 teeth Crown Gear	1.6	3.5	2.0	17.1	
1	20 teeth Spur Gears	1.6	1.5	2.2	10.8	
1	24 teeth Spur Gears	1.6	1.5	2.0	12.8	
1	30 teeth Spur Gears	1.6	1.5	2.0	14.9	
1	30 teeth Spur Gears	1.6	1.5	2.5	14.9	
1	30 teeth Spur Gears	1.6	2.5	3.0	14.9	
1	32 teeth Spur Gears	1.6	1.5	2.0	16.8	
1	36 teeth Spur Gears	1.6	1.5	2	18.9	
1	40 teeth Spur Gears	1.6	1.5	2	20.8	
1	42 teeth Spur Gears	1.6	1.5	2.0	22.9	
1	48 teeth Spur Gears	1.6	1.5	2.0	24.9	
1	56 teeth Spur Gears	1.6	1.5	2.0	28.8	
1	8/20 teeth Pinion / Crown Gear	1.6	5/3	2.2	5/11	
1	8/28 teeth Pinion / Crown Gear	1.6	5/3	2.2	5/15	
1	10/28 teeth Pinion / Crown Gear	1.6	5/3	2.5	9/15	
1	10/30 teeth Pinion / Crown Gear	1.6	5/3	2.2	6/16	
1	10/40 teeth Pinion / Crown Gear	1.6	5/3	2.2	5/21	
1	8/20 teeth Double Pinion Gear	1.6	4/1.5	2.2	5/11	
1	8/22 teeth Double Pinion Gear	1.6	4/1.5	2.0	5/12	
1	10/16 teeth Double Pinion Gear	1.6	4/3.5	2.2	6/9	
1	10/18 teeth Double Pinion Gear	1.6	4/1.5	2.0	6/9.8	
1	10/20 teeth Double Pinion Gear	1.6	4/1.5	2.2	6/11	
1	10/22 teeth Double Pinion Gear	1.6	4/1.5	2.2	6/11.9	
1	10/24 teeth Double Pinion Gear	1.6	4/1.5	2.2	6/12.9	
1	12/24 teeth Double Pinion Gear	1.6	4/1.5	2.2	7/12.9	
1	8/26 teeth Double Pinion Gear	1.6	4/1.5	2.2	5/13.9	
1	10/28 teeth Double Pinion Gear	1.6	4/1.5	2.2	6/14.9	
1	12/30 teeth Double Pinion Gear	1.6	4/1.5	2.2	6.9/15.9	
1	16/30 teeth Double Pinion Gear	1.6	4/1.5	2.2	9/15.9	
1	8/32 teeth Double Pinion Gear	1.6	4/1.5	2.2	5/16.9	
1	10/34 teeth Double Pinion Gear	1.6	4/1.5	2.2	6/17.9	
1	8/38 teeth Double Pinion Gear	1.6	4/1.5	2.2	5/19.9	
1	10/40 teeth Double Pinion Gear	1.6	4/1.5	2.2	6/20.9	
1	8/46 teeth Double Pinion Gear	1.6	4/1.5	2.0	5/23.9	
1	10/48 teeth Double Pinion Gear	1.6	4/1.5	2.2	6/24.9	
1	10/50 teeth Double Pinion Gear	1.6	4/1.5	2.2	6/25.9	
2	83 toothed Rack	1.6	4.0			125
1	16 teeth Bevel Gear	1.6	5.0	2.0	11.3	
1	10 teeth Pinion Gear / Pulley	1.6	4/3.5	2.2	6/11.1	
1	12 teeth Pinion Gear / Pulley	1.6	4/4.2	2.2	6.9/13.4	
1	Pulley ID = 3.7		5.0	2.0	3.7	
1	Pulley ID = 10.3		5.0	2.2	10.3	
1	Pulley ID = 13.8		4.5	2.2	13.8	
1	Pulley ID = 15.6		5.5	2.2	16.6	
1	Pulley ID = 21.3		4.0	2.2	21.3	
1	Tee collar		4.0	2.0		6.0
1	Axle Sleeve set 2, OR		1.9	2.0	5.0	
1	Axle Sleeve set 2, GR		1.9	2.5	6.0	
1	Axle Sleeve set 2, PK		2.5	3.0	5.2	
5	Assorted Rubber Belt					