

TA1020 Through core type precision current transformer **YHDC** 1992®

Characteristics:

Epoxy resin encapsulated, mini outline size, fully enclosed. Beautiful appearance.

Technical index:

Mounting type: PCB
 Material of the core: Nanocrystalline
 Flame resistance: UL94-V0
 Execution standard: GB20840-2014
 Operating temperature: -35°C~+85°C
 Storage temperature: -45°C~+95°C
 Frequency range: 20Hz-20KHz
 Dielectric strength: $\geq 3.5\text{KV}$ 50Hz 1min

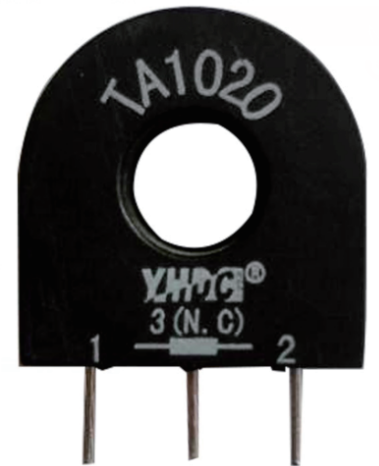

Electrical parameters: (The following parameters are typical values and actual values will be subject to product testing)

Model	TA020				Unit
Rated input	5	10	15	20	A
Rated output	5	10	15	20	mA
Turns ratio	1: 1000				
Linearity	≤ 0.3				%
Sampling resistance	50				Ω
Weight	11				g

Schematic diagram:

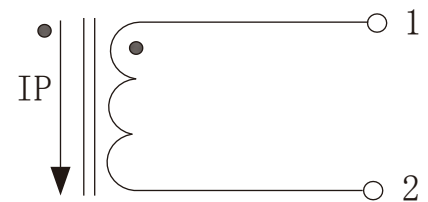

current output type.
 the secondary is not allowed to open.
 (pin 3 are null.)

Dimensions (in mm ± 0.5) :

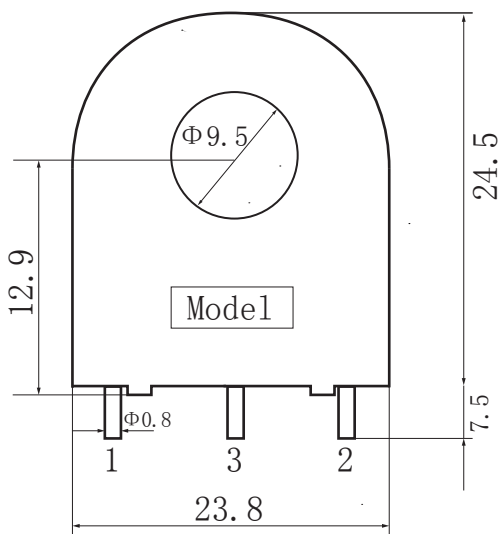

Front view

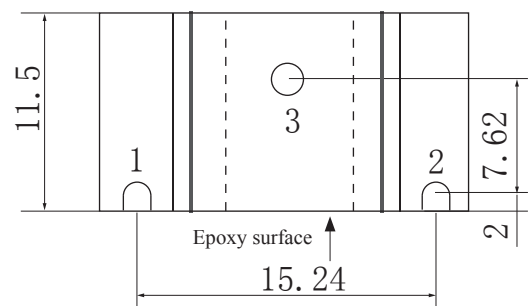
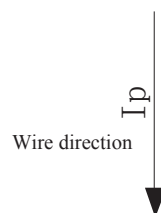

Bottom view