

RoHS COMPLIANT

REV.	ECN NO.	DESCRIPTION	DATE
A		REDRAWN	NOV.02'01
B		MODIFY P/N	MAR.02'11

A

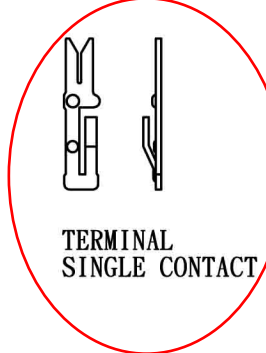
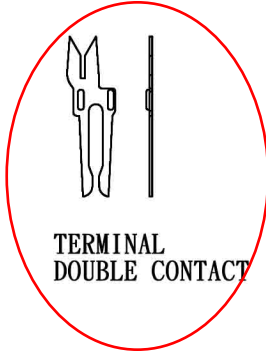
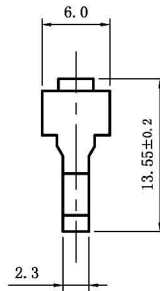
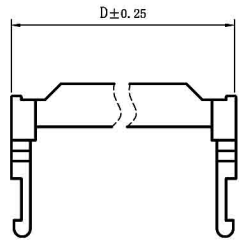

**Material:**  
 Insulator: PBT+Glass Fiber (UL94V-0).  
 Contact: Copper Alloy.  
 Contact Plated: Gold or Tin over Nickel Plated.

B

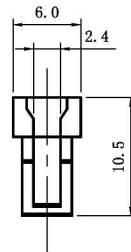
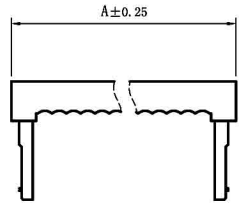

TERMINAL DOUBLE CONTACT

TERMINAL SINGLE CONTACT

**Specification:**  
 Withstanding Voltage: AC 500V for 1 Minute.  
 Insulation Resistance: 100 MΩ Min. at DC 500V.  
 Contact Resistance: 1 Ω Max..  
 Operating Temperature: -40°C — +105°C.

C

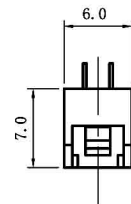
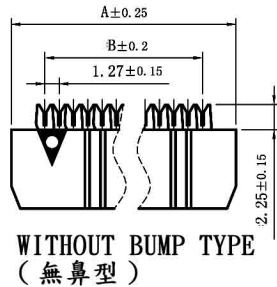

Ordering Information

SC \*\* \* \* 11 -1C  
a b c d

- a. No. Of Pins
- b. Plating :  
G : Gold plating over all.  
T : Tin/Gold plating.
- c. Option On Strain Relief  
A : With strain relief.  
B : Without strain relief.
- d. Contact Type  
BLANK : Double contact  
1C : Single contact

Pos.	Dim. A	Dim. B	Dim. C	Dim. D	Dim. E
6	12.02	6.35	5.08	12.02	1.9
8	14.50	8.89	7.62	14.50	1.9
10	17.40	11.43	10.16	17.20	3.8
12	19.94	13.97	12.70	19.74	3.8
14	22.48	16.51	15.24	22.28	3.8
16	25.02	19.05	17.78	24.82	3.8
18	27.56	21.59	20.32	27.36	3.8
20	30.10	24.13	22.86	29.90	3.8
24	35.18	29.21	27.94	34.98	3.8
26	37.72	31.75	30.48	37.52	3.8
30	42.80	36.83	35.56	42.80	3.8
34	47.88	41.91	40.64	47.68	3.8
40	55.50	49.53	48.26	55.30	3.8
44	60.58	54.61	53.34	60.38	3.8
50	68.20	62.23	60.96	68.40	3.8
60	80.90	74.93	73.66	80.70	3.8
64	85.98	80.01	78.74	85.78	3.8

D

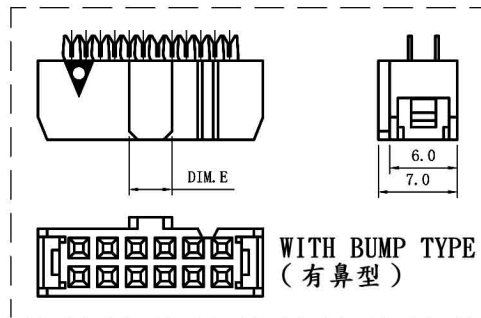
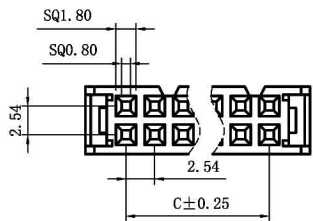

TOLERANCE UNLESS OTHERWISE SPECIFIED		PROJECTION	GOLD-TEK ELECTRIC CO., LTD.	
LINEAR	ANGLE	UNITS	TITLE	PART NO.
X. ±	X' ±	MM [INCH]	IDC SOCKET PITCH: 2.54MM	SC****11(-1C)
.X ± 0.2	.X' ±	SCALE	ROW TO ROW 2.54MM	CAD NO. 1579
.XX ± 0.10	.XX' ±	SIZE	CPART NO	SHEET
.XXX ±	.XXX' ±	A4		1 OF 1
APPD				
CHKD				
DRAW	Z	MAR.02'2011		

圖面編號:GTKSD0254-B(1)