

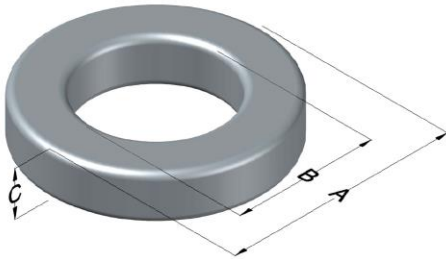

0055208A2

110 Delta Drive
 Pittsburgh, PA 15238
 NAFTA Sales: (1)800-245-3984
 HK Sales : (852)3102-9337
 magnetics@spang.com
 www.mag-inc.com



MPP Permeability (μ)	A_L (nH/T ²)	Core Marking			Coating Color
		Lot Number	Part Number	Inductance Grade	
26	14 \pm 8%	XXXXXX	55208A2	N/A	Gray

Dimensions	Uncoated		Coated Limits			Packaging
	(mm)	(in)	(mm)	(in)		
OD (A)	20.3	0.800	21.1	0.830	max	Bulk Pack 4 bags/box Box Qty=1600 pcs
ID (B)	12.7	0.500	12.0	0.475	min	
HT (C)	6.35	0.250	7.12	0.280	max	

Electrical Characteristics			Physical Characteristics						
Watt Loss @ 100 kHz, 100mT max(mW/cm ³)	DC Bias min (oersteds)		Voltage Breakdown wire to wire min (V _{AC})	Break Strength min (kg)	Window Area W _A (mm ²)	Cross Section A _e (mm ²)	Path Length L _e (mm)	Volume V _e (mm ³)	Weight (g)
	800	80% 120							

Winding Information					Temperature Rating	
Winding Length Per Turn				Wound Coil Dimensions (mm)		Curie Temp: 460 °C
Winding Factor	(mm)	Winding Factor	(mm)	40% Winding Factor		Coating Temp (Continuous up to): 200 °C
				OD	22.9	Notes:
				HT	10.7	
				Completely Full Window		Max OD
0%	23.3	40%	29.5	Max HT	17.4	
20%	26.4	45%	30.5	Surface Area (mm ²)		
25%	27.2	50%	31.3	Unwound Core		
30%	27.8	60%	33.2	40% Winding Factor		
35%	28.8	70%	35.4	1,200		
				1,900		

Typical DC Bias Performance

