

# Brighter World Brighter Life

更明亮的世界·更明亮的人生

## Optoelectronics Through Hole Lamp



Provide LED Total Solution Since 1981  
提供LED全方面的解決方案



佰鴻工業股份有限公司  
Bright Led Electronics Corp.





## CONTENTS

● 3mm Round Type	5
● 4mm Round Type	14
● 5mm Round Type	14
● Blinking Lamp Type	22
● Resistor Lamp Type	22
● 8mm Round Type	23
● 10mm Round Type	23
● Rectangular	24
● Cylindrical	30
● Tower	31
● Triangular	32
● Ellipse	32
● Holder Assembly	33

### 3MM ROUND TYPE

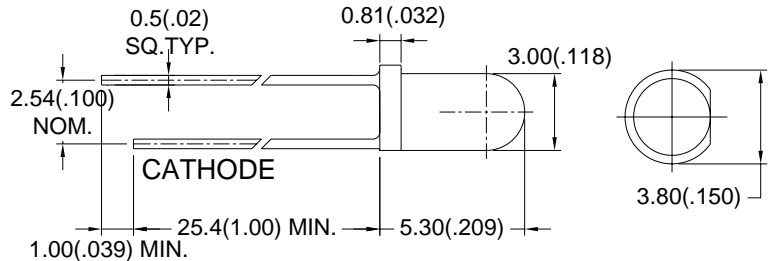

Unit: mm (inch)

Part No.	Emitted Color	$\lambda d$ (nm)	Lens Appearance	Vf(V) @ I <sub>F</sub> =20mA		IV(mcd) @ I <sub>F</sub> =20mA	Viewing Angle 2θ <sub>1/2</sub> (deg)
				Typ	Max	Typ	
BL-BB53V1	Blue	460-475	Transparent	3.2	3.6	3000	30
BL-BG83V1	Green	520-535	Transparent	3.2	3.6	5550	30
BL-B2141	Yellow Green	566-576	Color Diffused	2.2	2.6	40	35
BL-B3141	Yellow	580-595	Color Diffused	2.1	2.6	45	35
BL-BJC3V1	Amber	600-612	Transparent	2.0	2.6	2300	30
BL-BJZ3V1	Orange Red	620-630	Transparent	2.0	2.6	6775	30
BL-BUF341	Red	625-637	Transparent	2.1	2.6	800	30
BL-BZ73V1	White	X=0.32, Y=0.31	Transparent	3.2	3.6	3100	30

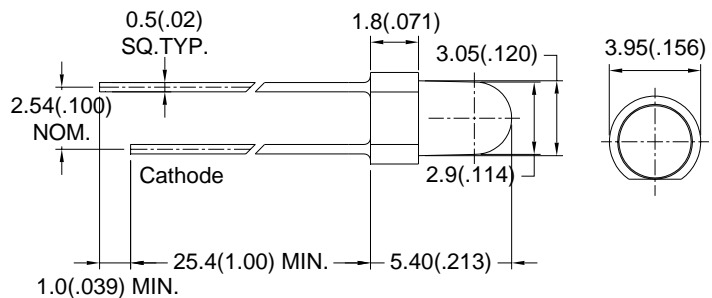

Unit: mm (inch)

Part No.	Emitted Color	$\lambda d$ (nm)	Lens Appearance	Vf(V) @ I <sub>F</sub> =20mA		IV(mcd) @ I <sub>F</sub> =20mA	Viewing Angle 2θ <sub>1/2</sub> (deg)
				Typ	Max	Typ	
BL-BB51V1G	Blue	460-475	Color Diffused	3.2	3.6	260	35
BL-B2141G	Yellow Green	566-576	Color Diffused	2.2	2.6	40	35
BL-B3141G	Yellow	580-595	Color Diffused	2.1	2.6	35	35
BL-BJD3V1G	Orange Red	615-628	Transparent	2.0	2.6	3500	30
BL-BUF4V1G	Red	625-637	Color Transparent	2.1	2.6	1800	30

### 3MM ROUND TYPE

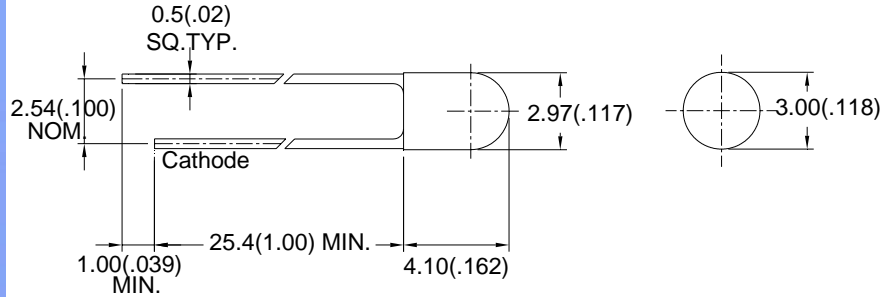

Unit: mm (inch)

Part No.	Emitted Color	$\lambda d$ (nm)	Lens Appearance	Vf(V) @ I <sub>F</sub> =20mA		IV(mcd) @ I <sub>F</sub> =20mA	Viewing Angle 2θ <sub>1/2</sub> (deg)
				Typ	Max	Typ	
BL-B2141N	Yellow Green	566-576	Color Diffused	2.2	2.6	50	55
BL-B3341N	Yellow	580-595	Transparent	2.1	2.6	70	50
BL-B4341N	Red	625-638	Transparent	2.0	2.6	60	50

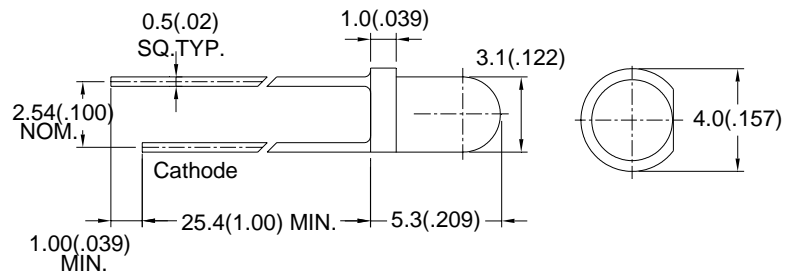

Unit: mm (inch)

Part No.	Emitted Color	$\lambda d$ (nm)	Lens Appearance	Vf(V) @ I <sub>F</sub> =20mA		IV(mcd) @ I <sub>F</sub> =20mA	Viewing Angle 2θ <sub>1/2</sub> (deg)
				Typ	Max	Typ	
BL-BBX1V1A	Blue	460-475	Color Diffused	3.2	3.6	340	35
BL-B3141A	Yellow	580-595	Color Diffused	2.1	2.6	35	35
BL-BSA1V1A	Red	638-648	Color Diffused	1.8	2.6	50	35

## 3MM ROUND TYPE

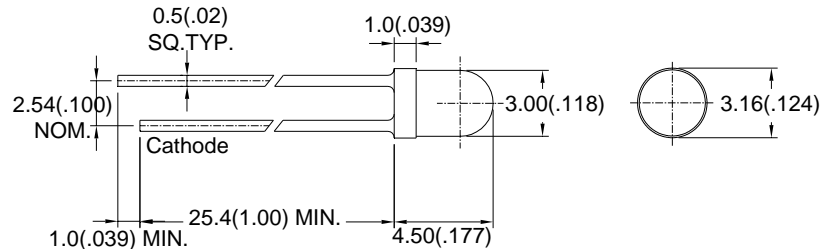

Unit: mm (inch)

Part No.	Emitted Color	$\lambda d$ (nm)	Lens Appearance	Vf(V) @ I <sub>F</sub> =20mA		IV(mcd) @ I <sub>F</sub> =20mA	Viewing Angle 2θ <sub>1/2</sub> (deg)
				Typ	Max	Typ	
BL-BB53V1K	Blue	460-475	Transparent	3.2	3.6	1500	30
BL-BGE3V1K	Yellow Green	566-576	Transparent	2.0	2.6	465	30
BL-BKC1V1K	Yellow	586-594	Color Diffused	2.0	2.6	560	45
BL-BJE5V1K	Orange Red	615-628	Color Diffused	2.0	2.6	500	45
BL-BUB3V1K	Red	624-634	Transparent	2.0	2.6	700	30
BL-BZ53V1K	White	X=0.32.Y=0.31	Transparent	3.2	3.6	2700	30

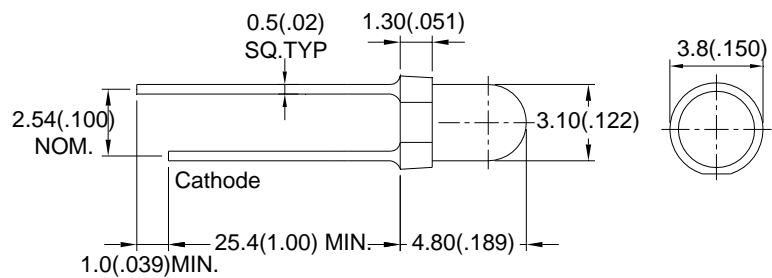

Unit: mm (inch)

Part No.	Emitted Color	$\lambda d$ (nm)	Lens Appearance	Vf(V) @ I <sub>F</sub> =20mA		IV(mcd) @ I <sub>F</sub> =20mA	Viewing Angle 2θ <sub>1/2</sub> (deg)
				Typ	Max	Typ	
BL-BG83V1Q	Green	520-535	Transparent	3.2	3.6	5000	35
BL-B2141Q	Yellow Green	566-576	Color Diffused	2.2	2.6	40	35
BL-BKC341Q	Yellow	586-594	Transparent	2.0	2.6	1400	35
BL-B8341Q	Amber	600-615	Transparent	2.0	2.6	100	35
BL-BJE341Q	Orange Red	615-628	Transparent	2.0	2.6	1000	35

## 3MM ROUND TYPE

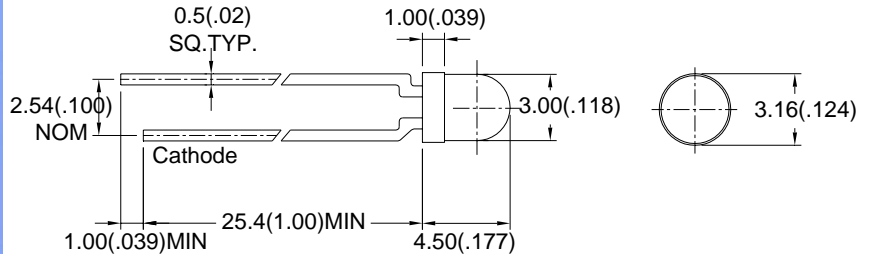

Unit: mm (inch)

Part No.	Emitted Color	$\lambda d$ (nm)	Lens Appearance	Vf(V) @ $I_F=20mA$		IV(mcd) @ $I_F=20mA$	Viewing Angle $2\theta_{1/2}$ (deg)
				Typ	Max	Typ	
BL-B2181K-3	Yellow Green	566-576	Color Diffused	2.2	2.6	35	65
BL-BGE181K-3	Yellow Green	566-576	Color Diffused	2.0	2.6	100	65
BL-B3181K-3	Yellow	580-595	Color Diffused	2.1	2.6	40	65
BL-BKC181K-3	Yellow	586-594	Color Diffused	2.0	2.6	350	65
BL-BUB181K-3	Red	624-634	Color Diffused	2.0	2.6	280	65

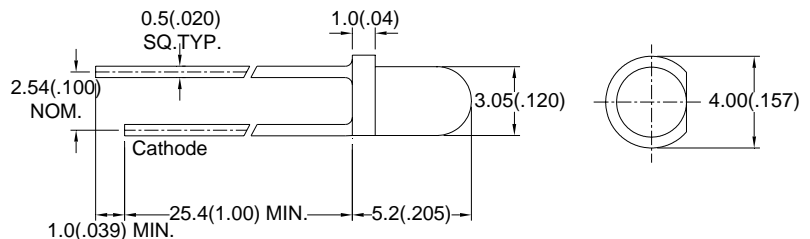

Unit: mm (inch)

Part No.	Emitted Color	$\lambda d$ (nm)	Lens Appearance	Vf(V) @ $I_F=20mA$		IV(mcd) @ $I_F=20mA$	Viewing Angle $2\theta_{1/2}$ (deg)
				Typ	Max	Typ	
BL-BB53V1X	Blue	460-475	Transparent	3.2	3.6	1200	35
BL-BG83V1X	Green	520-535	Transparent	3.2	3.6	4400	35
BL-BJL391X	Orange Red	620-630	Transparent	2.1	2.6	4800	30
BL-BJD541X	Orange Red	620-630	Color Diffused	2.0	2.6	700	65



### 3MM ROUND TYPE

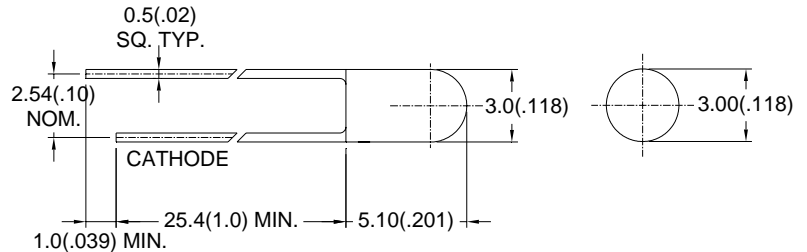

Unit: mm (inch)

Part No.	Emitted Color	$\lambda d$ (nm)	Lens Appearance	Vf(V) @ $I_F=20mA$		IV(mcd) @ $I_F=20mA$	Viewing Angle $2\theta_{1/2}$ (deg)
				Typ	Max	Typ	
BL-BB53V1J	Blue	460-475	Transparent	3.2	3.6	2100	30
BL-BG83V1J	Green	520-535	Transparent	3.2	3.6	6500	30
BL-B21V1J	Yellow Green	566-576	Color Diffused	2.2	2.6	40	35
BL-BKC341J	Yellow	586-594	Transparent	2.0	2.6	750	30
BL-BJE3V1J	Orange Red	615-628	Transparent	2.0	2.6	1000	30
BL-BUB1V1J	Red	624-634	Color Diffused	2.0	2.6	317	35
BL-B45V1J	Red	625-638	Color Diffused	2.0	2.6	35	35
BL-BZD3V1J	White	X=0.32,Y=0.31	Transparent	3.2	3.6	4060	30

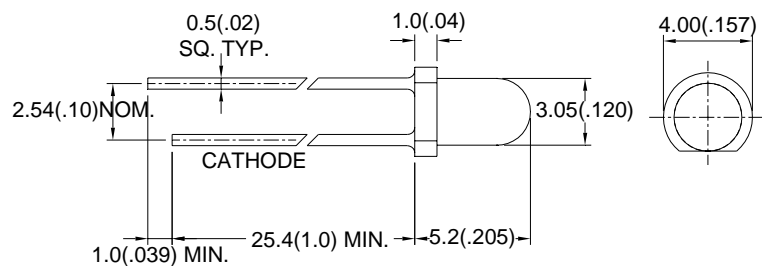

Unit: mm (inch)

Part No.	Emitted Color	$\lambda d$ (nm)	Lens Appearance	Vf(V) @ $I_F=20mA$		IV(mcd) @ $I_F=20mA$	Viewing Angle $2\theta_{1/2}$ (deg)
				Typ	Max	Typ	
BL-BGE341F	Yellow Green	566-576	Transparent	2.0	2.6	420	40
BL-B31V1F	Yellow	580-595	Color Diffused	2.1	2.6	40	50

### 3MM ROUND TYPE

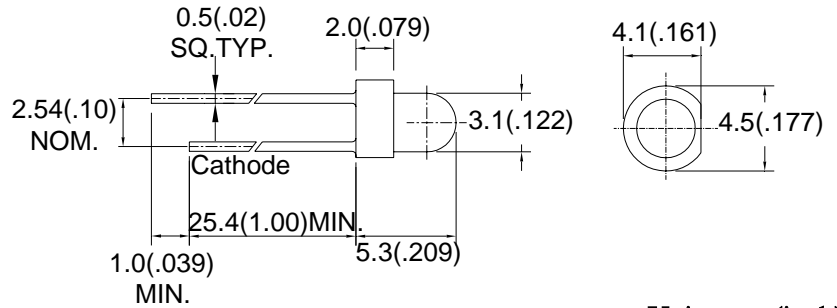

Unit: mm (inch)

Part No.	Emitted Color	$\lambda d$ (nm)	Lens Appearance	Vf(V) @ I <sub>F</sub> =20mA		IV(mcd) @ I <sub>F</sub> =20mA	Viewing Angle 2θ <sub>1/2</sub> (deg)
				Typ	Max	Typ	
BL-BB51V1L	Blue	460-475	Color Diffused	3.2	3.6	380	45
BL-B2141L	Yellow Green	566-576	Color Diffused	2.2	2.6	35	45
BL-B3141L	Yellow	580-595	Color Diffused	2.1	2.6	40	45
BL-B4541L	Red	625-638	Color Diffused	2.1	2.6	35	45
BL-BSA4V1L	Red	638-648	Transparent	1.8	2.6	90	40

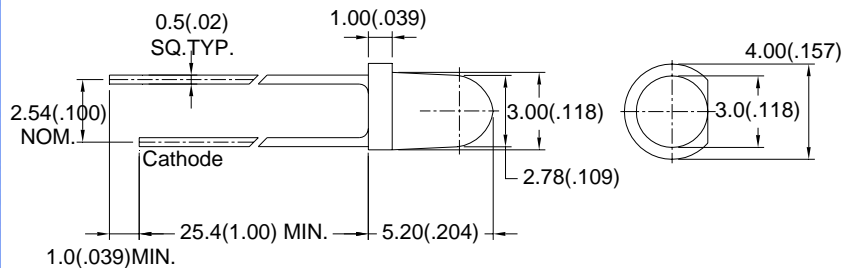

Unit: mm (inch)

Part No.	Emitted Color	$\lambda d$ (nm)	Lens Appearance	Vf(V) @ I <sub>F</sub> =20mA		IV(mcd) @ I <sub>F</sub> =20mA	Viewing Angle 2θ <sub>1/2</sub> (deg)
				Typ	Max	Typ	
BL-BJX3V1M	Red	620-630	Transparent	2.0	2.6	18000	20
BL-BUF4V1M	Red	625-637	Color Transparent	2.1	2.6	1200	15
BL-BSA3V1M	Red	638-648	Transparent	1.8	2.6	340	15



## 3MM ROUND TYPE

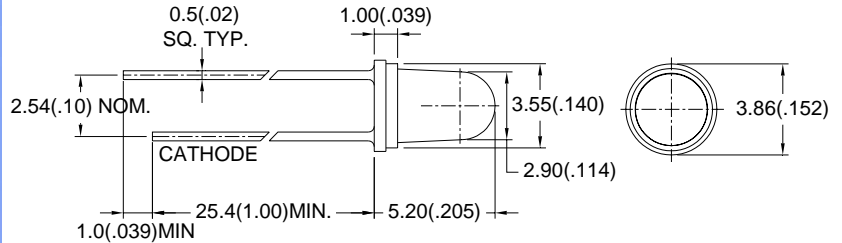

Unit: mm (inch)

Part No.	Emitted Color	$\lambda d$ (nm)	Lens Appearance	Vf(V) @ $I_F=20mA$		IV(mcd) @ $I_F=20mA$	Viewing Angle $2\theta_{1/2}$ (deg)
				Typ	Max	Typ	
BL-BB53V1T	Blue	460-475	Transparent	3.2	3.6	1750	30
BL-B2441T	Yellow Green	566-576	Color Transparent	2.2	2.6	80	30
BL-B31V1T	Yellow	580-595	Color Diffused	2.1	2.6	40	45
BL-BJE3V1T	Orange Red	615-628	Transparent	2.0	2.6	900	30
BL-B4541T	Red	625-638	Color Diffused	2.1	2.6	35	45

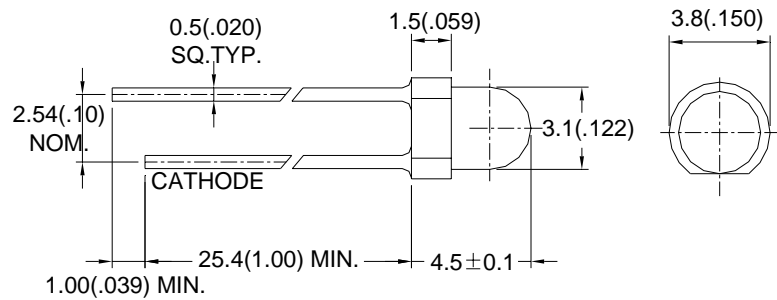

Unit: mm (inch)

Part No.	Emitted Color	$\lambda d$ (nm)	Lens Appearance	Vf(V) @ $I_F=20mA$		IV(mcd) @ $I_F=20mA$	Viewing Angle $2\theta_{1/2}$ (deg)
				Typ	Max	Typ	
BL-BB53V1W	Blue	460-475	Transparent	3.2	3.6	1500	30
BL-B2141W	Yellow Green	566-576	Color Diffused	2.2	2.6	50	40
BL-B4641W	Red	625-638	Color Transparent	2.0	2.6	100	40
BL-BZD3V1W	White	X=0.32, Y=0.31	Transparent	3.2	3.6	2500	30

### 3MM ROUND TYPE

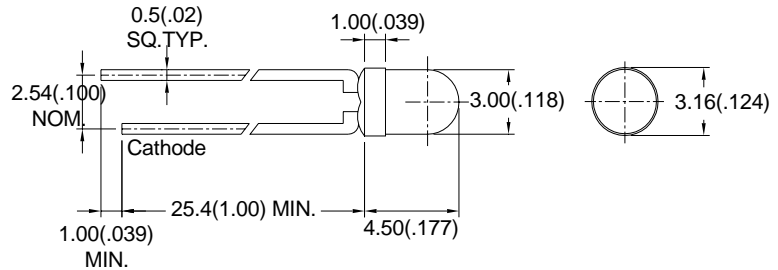

Unit: mm (inch)

Part No.	Emitted Color	$\lambda d$ (nm)	Lens Appearance	Vf(V) @ I <sub>F</sub> =20mA		IV(mcd) @ I <sub>F</sub> =20mA	Viewing Angle 2θ <sub>1/2</sub> (deg)
				Typ	Max	Typ	
BL-B2131K	Yellow Green	566-576	Color Diffused	2.2	2.6	60	45
BL-B3331K	Yellow	580-595	Transparent	2.1	2.6	65	30
BL-BSA131K	Red	638-648	Color Diffused	1.8	2.6	80	45

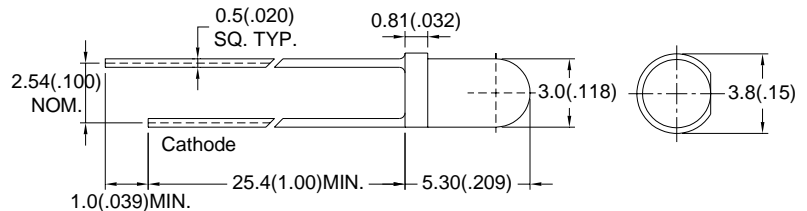

Unit: mm (inch)

Part No.	Emitted Color	$\lambda d$ (nm)	Lens Appearance	Vf(V) @ I <sub>F</sub> =20mA		IV(mcd) @ I <sub>F</sub> =20mA	Viewing Angle 2θ <sub>1/2</sub> (deg)
				Typ	Max	Typ	
BL-BEG271	Red	617-638	White Diffused	2.1	2.6	13	45
	Yellow Green	566-576		2.2	2.6	13	
BL-BUBGE271	Red	624-634	White Diffused	2.0	2.6	110	45
	Yellow Green	566-576		2.0	2.6	45	
BL-BYY171	Yellow	580-595	Color Diffused	2.0	2.6	10	45
BL-BEE571	Red	617-638	Color Diffused	2.1	2.6	4.0	45

### 3MM ROUND TYPE

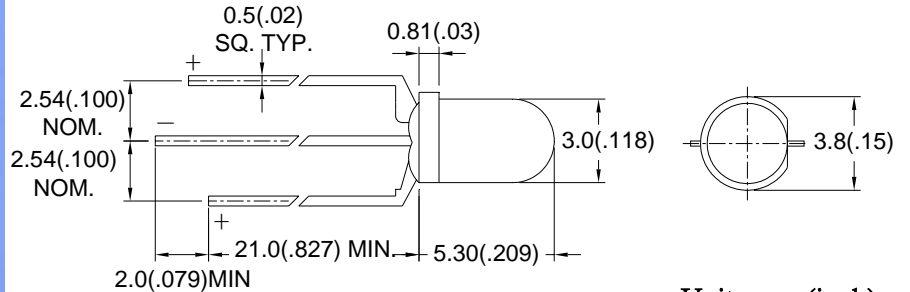

Unit: mm (inch)

Part No.	Emitted Color	$\lambda d$ (nm)	Lens Appearance	Vf(V) @ I <sub>F</sub> =20mA		IV(mcd) @ I <sub>F</sub> =20mA	Viewing Angle 2θ <sub>1/2</sub> (deg)
				Typ	Max	Typ	
BL-BEG201	Red	617-638	White Diffused	2.0	2.6	30	40
	Yellow Green	566-576		2.2	2.6	35	
BL-BUBGE201	Red	624-634	White Diffused	2.0	2.6	220	40
	Yellow Green	566-576		2.0	2.6	100	

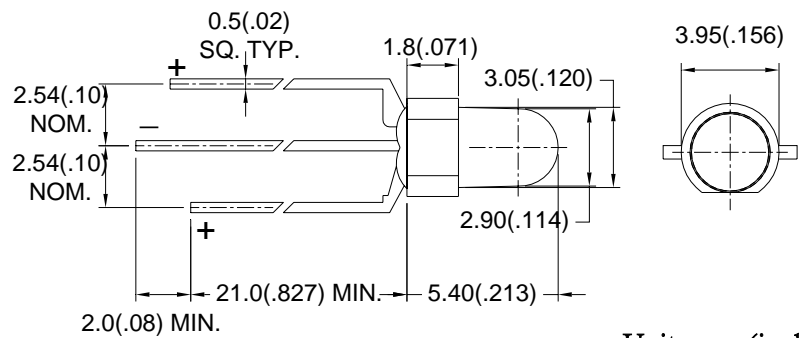

Unit: mm (inch)

Part No.	Emitted Color	$\lambda d$ (nm)	Lens Appearance	Vf(V) @ I <sub>F</sub> =20mA		IV(mcd) @ I <sub>F</sub> =20mA	Viewing Angle 2θ <sub>1/2</sub> (deg)
				Typ	Max	Typ	
BL-BUBBD301G	Red	624-634	Transparent	2.0	2.6	1100	30
	Blue	460-475		3.2	3.6	500	
BL-BEG201G	Red	617-638	White Diffused	2.0	2.6	30	40
	Yellow Green	566-576		2.2	2.6	30	
BL-BJDB5201G	Orange Red	615-625	White Diffused	2.0	2.6	500	40
	Blue	460-475		3.2	3.6	250	

## 4MM ROUND TYPE

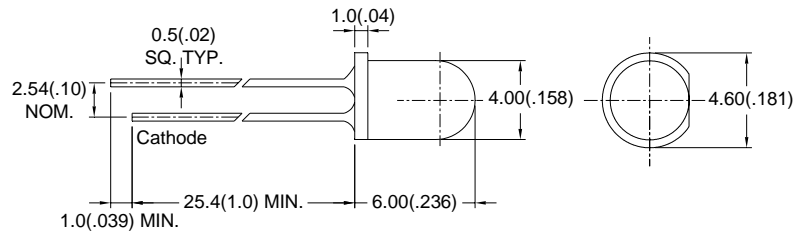

Unit: mm (inch)

Part No.	Emitted Color	$\lambda d$ (nm)	Lens Appearance	Vf(V) @ I <sub>F</sub> =20mA		IV(mcd) @ I <sub>F</sub> =20mA	Viewing Angle 2θ <sub>1/2</sub> (deg)
				Typ	Max	Typ	
BL-B2132	Yellow Green	566-576	Color Diffused	2.2	2.6	40	55
BL-B4532	Red	625-638	Color Diffused	2.1	2.6	60	55

## 5MM ROUND TYPE

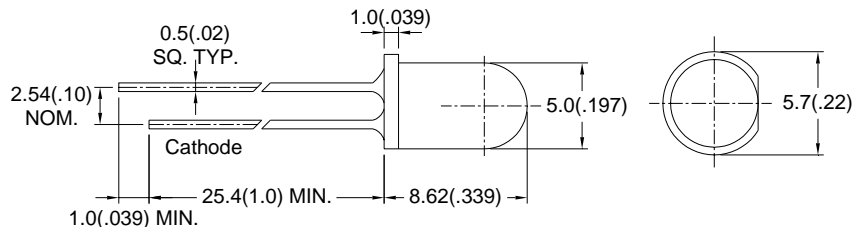

Unit: mm (inch)

Part No.	Emitted Color	$\lambda d$ (nm)	Lens Appearance	Vf(V) @ I <sub>F</sub> =20mA		IV(mcd) @ I <sub>F</sub> =20mA	Viewing Angle 2θ <sub>1/2</sub> (deg)
				Typ	Max	Typ	
BL-BEG274	Red	617-638	White Diffused	2.0	2.6	10	50
	Yellow Green	566-576		2.2	2.6	20	
BL-BUFGE274	Red	625-637	White Diffused	2.1	2.6	150	50
	Yellow Green	566-576		2.2	2.6	48	
BL-BYG374	Yellow	580-595	Transparent	2.1	2.6	40	50
	Yellow Green	566-576		2.2	2.6	50	
BL-BKTG8274	Yellow	586-594	White Diffused	2.0	2.6	660	50
	Green	520-535		3.2	3.6	380	

## 5MM ROUND TYPE

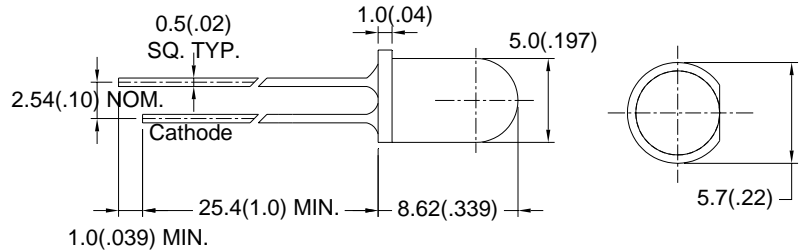

Unit: mm (inch)

Part No.	Emitted Color	$\lambda d$ (nm)	Lens Appearance	Vf(V) @ I <sub>F</sub> =20mA		IV(mcd) @ I <sub>F</sub> =20mA	Viewing Angle 2θ <sub>1/2</sub> (deg)
				Typ	Max	Typ	
BL-BB51V4	Blue	460-475	Color Diffused	3.2	3.6	500	35
BL-B2134	Yellow Green	566-576	Color Diffused	2.2	2.6	40	35
BL-BGE334	Yellow Green	566-576	Transparent	2.0	2.6	1400	12
BL-B3134	Yellow	580-595	Color Diffused	2.1	2.6	35	35
BL-BKC334	Yellow	582-592	Transparent	2.1	2.6	3200	12
BL-BJC234	Amber	600-612	White Diffused	2.0	2.6	750	15
BL-BA1134	Amber	603-615	Color Diffused	2.1	2.6	60	35
BL-BJY534	Orange Red	620-630	Color Diffused	2.0	2.6	850	35
BL-BUF334	Red	625-637	Transparent	2.1	2.6	3600	12

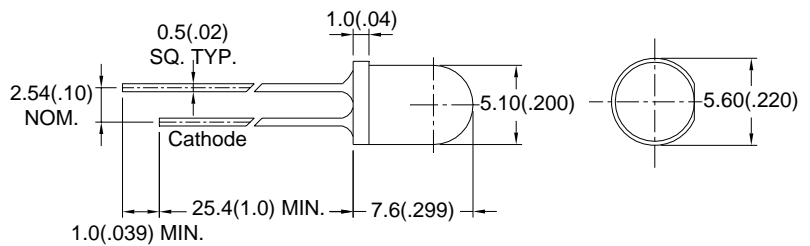

Unit: mm (inch)

Part No.	Emitted Color	$\lambda d$ (nm)	Lens Appearance	Vf(V) @ I <sub>F</sub> =20mA		IV(mcd) @ I <sub>F</sub> =20mA	Viewing Angle 2θ <sub>1/2</sub> (deg)
				Typ	Max	Typ	
BL-B2134Q	Yellow Green	566-576	Color Diffused	2.2	2.6	80	55
BL-BUF134Q	Red	625-637	Color Diffused	2.1	2.6	280	55

## 5MM ROUND TYPE

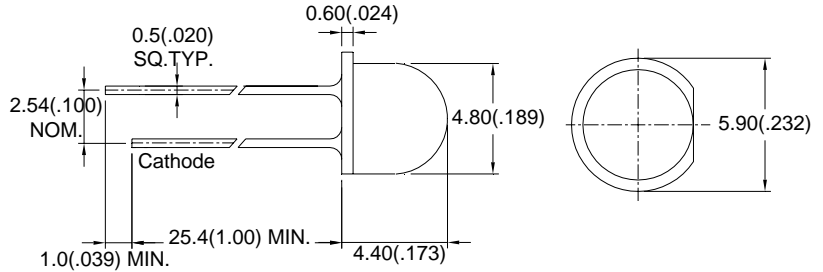

Unit: mm (inch)

Part No.	Emitted Color	$\lambda d$ (nm)	Lens Appearance	Vf(V) @ I <sub>F</sub> =20mA		IV(mcd) @ I <sub>F</sub> =20mA	Viewing Angle 2θ <sub>1/2</sub> (deg)
				Typ	Max	Typ	
BL-BBE3K4B	Blue	460-475	Transparent	3.2	3.6	1600	60
BL-B4534B	Red	625-638	Color Diffused	2.1	2.6	25	30
BL-BUF334B	Red	625-637	Transparent	2.1	2.6	570	30

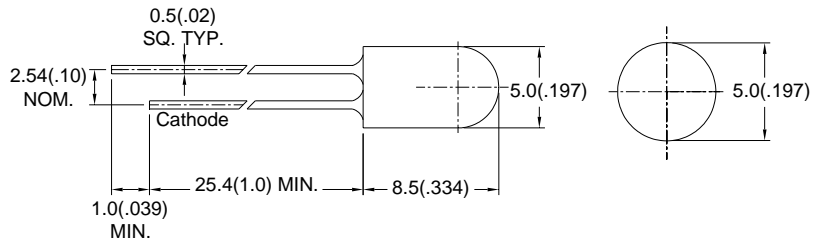

Unit: mm (inch)

Part No.	Emitted Color	$\lambda d$ (nm)	Lens Appearance	Vf(V) @ I <sub>F</sub> =20mA		IV(mcd) @ I <sub>F</sub> =20mA	Viewing Angle 2θ <sub>1/2</sub> (deg)
				Typ	Max	Typ	
BL-BB31V4N	Blue	460-475	Color Diffused	3.2	3.6	600	35
BL-B2134N	Yellow Green	566-576	Color Diffused	2.2	2.6	45	40
BL-B3434N	Yellow	580-595	Color Transparent	2.1	2.6	210	20
BL-BKC134N	Yellow	586-594	Color Diffused	2.0	2.6	470	40
BL-BJY3V4N	Orange Red	620-630	Transparent	2.0	2.6	4200	20
BL-B4534N	Red	625-638	Color Diffused	2.1	2.6	40	40
BL-BUF334N	Red	625-637	Transparent	2.1	2.6	1100	20



## 5MM ROUND TYPE

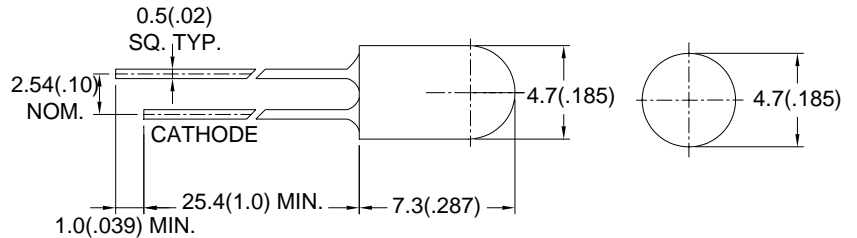

Unit: mm (inch)

Part No.	Emitted Color	$\lambda d$ (nm)	Lens Appearance	Vf(V) @ I <sub>F</sub> =20mA		IV(mcd) @ I <sub>F</sub> =20mA	Viewing Angle 2θ <sub>1/2</sub> (deg)
				Typ	Max	Typ	
BL-B2133	Yellow Green	566-576	Color Diffused	2.2	2.6	45	40
BL-B3133	Yellow	580-595	Color Diffused	2.1	2.6	65	40
BL-BSA133	Red	625-638	Color Diffused	2.1	2.6	65	40
BL-BUB1V3	Red	624-634	Color Diffused	2.0	2.6	320	60

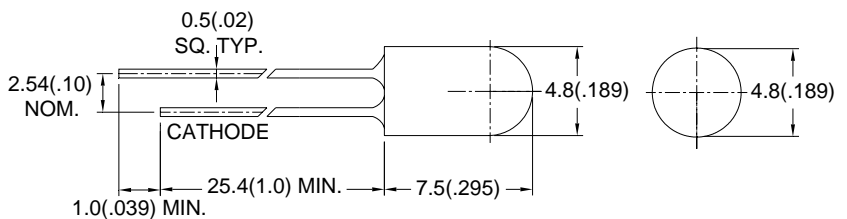

Unit: mm (inch)

Part No.	Emitted Color	$\lambda d$ (nm)	Lens Appearance	Vf(V) @ I <sub>F</sub> =20mA		IV(mcd) @ I <sub>F</sub> =20mA	Viewing Angle 2θ <sub>1/2</sub> (deg)
				Typ	Max	Typ	
BL-BB51V3N	Blue	460-475	Color Diffused	3.2	3.6	660	40
BL-B2133N	Yellow Green	566-576	Color Diffused	2.2	2.6	45	40
BL-B3133N	Yellow	580-595	Color Diffused	2.1	2.6	60	40
BL-BUB433N	Red	624-634	Transparent	2.0	2.6	850	40
BL-BSA133N	Red	625-638	Color Diffused	2.1	2.6	40	40

## 5MM ROUND TYPE

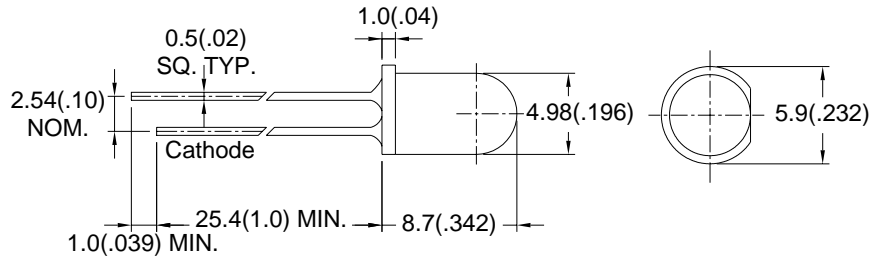

Unit: mm (inch)

Part No.	Emitted Color	$\lambda d$ (nm)	Lens Appearance	Vf(V) @ I <sub>F</sub> =20mA		IV(mcd) @ I <sub>F</sub> =20mA	Viewing Angle 2θ <sub>1/2</sub> (deg)
				Typ	Max	Typ	
BL-BB31V4V	Blue	460-475	Color Diffused	3.2	3.6	700	35
BL-BGE1V4V	Yellow Green	566-576	Color Diffused	2.0	2.6	150	35
BL-BKC3V4V	Yellow	586-594	Transparent	2.0	2.6	4000	15
BL-BJZ3V4V	Orange Red	616-628	Transparent	2.0	2.6	8000	15
BL-BUF1V4V	Red	625-637	Color Diffused	2.1	2.6	470	35
BL-BUF3V4V	Red	625-637	Transparent	2.1	2.6	1570	15
BZ-BZD3V4V	White	X=0.32, Y=0.31	Transparent	3.2	3.6	8500	15

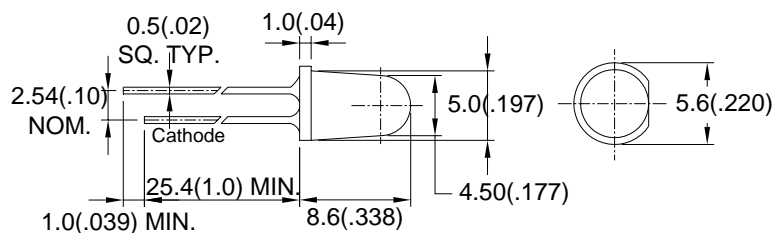

Unit: mm (inch)

Part No.	Emitted Color	$\lambda d$ (nm)	Lens Appearance	Vf(V) @ I <sub>F</sub> =20mA		IV(mcd) @ I <sub>F</sub> =20mA	Viewing Angle 2θ <sub>1/2</sub> (deg)
				Typ	Max	Typ	
BL-BG83V7M	Green	515-535	Transparent	3.2	3.6	30000	8
BL-BSA337M	Red	638-648	Transparent	1.8	2.6	700	8

## 5MM ROUND TYPE

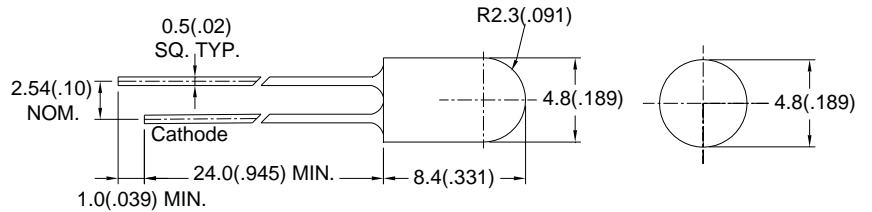

Unit: mm (inch)

Part No.	Emitted Color	$\lambda d$ (nm)	Lens Appearance	Vf(V) @ I <sub>F</sub> =20mA		IV(mcd) @ I <sub>F</sub> =20mA	Viewing Angle 2θ <sub>1/2</sub> (deg)
				Typ	Max	Typ	
BL-BGE3V7H	Yellow Green	566-576	Transparent	2.0	2.6	210	60
BL-BJD5V7H	Orange Red	620-630	Color Diffused	2.1	2.6	300	70

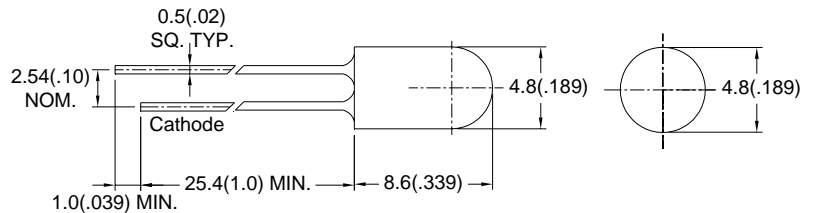

Unit: mm (inch)

Part No.	Emitted Color	$\lambda d$ (nm)	Lens Appearance	Vf(V) @ I <sub>F</sub> =20mA		IV(mcd) @ I <sub>F</sub> =20mA	Viewing Angle 2θ <sub>1/2</sub> (deg)
				Typ	Max	Typ	
BL-BB53V7N	Blue	460-475	Transparent	3.2	3.6	3700	20
BL-BJD3V7N	Red	625-638	Color Diffused	2.1	2.6	40	45
BL-BZ33V7N	White	X=0.32, Y=0.31	Water Clear	3.2	3.6	5800	20

## 5MM ROUND TYPE

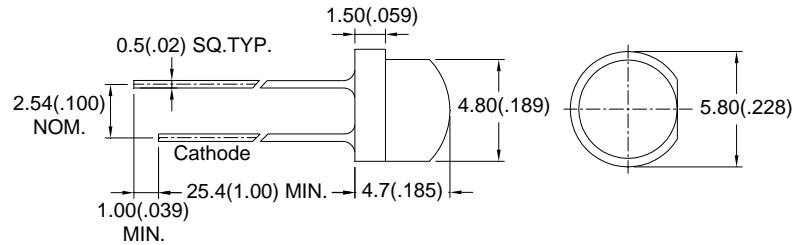

Unit: mm (inch)

Part No.	Emitted Color	$\lambda d$ (nm)	Lens Appearance	Vf(V) @ $I_F=20mA$		IV(mcd) @ $I_F=20mA$	Viewing Angle $2\theta_{1/2}$ (deg)
				Typ	Max	Typ	
BL-BB539B	Blue	460-475	Transparent	3.2	3.6	400	50
BL-BG839B	Green	515-535	Transparent	3.2	3.6	4800	50
BL-BJD3VB	Orange Red	625-640	Transparent	2.0	2.6	200	120

## 5MM ROUND TYPE

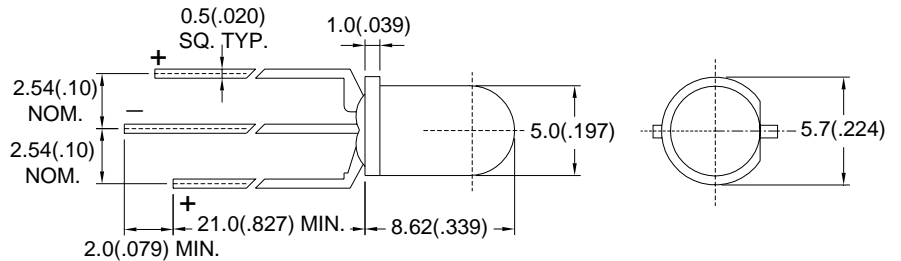

Unit: mm (inch)

Part No.	Emitted Color	$\lambda d$ (nm)	Lens Appearance	Vf(V) @ I <sub>F</sub> =20mA		IV(mcd) @ I <sub>F</sub> =20mA	Viewing Angle 2θ <sub>1/2</sub> (deg)
				Typ	Max	Typ	
BL-BEG204	Red	617-638	White Diffused	2.1	2.6	35	50
	Yellow Green	566-576		2.2	2.6	35	
BL-BJEB3204	Orange Red	615-625	White Diffused	2.0	2.6	500	50
	Blue	460-475		3.2	3.6	270	

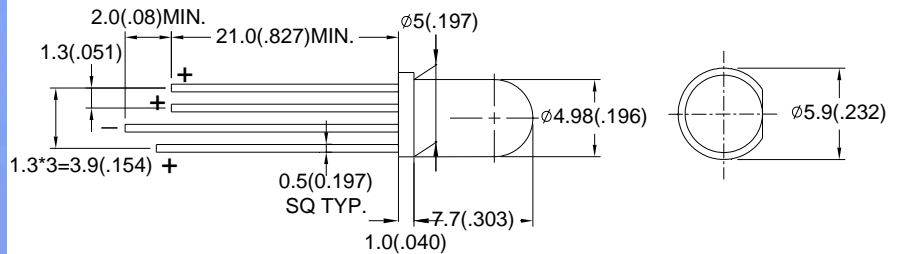

Unit: mm (inch)

Part No.	Emitted Color	$\lambda d$ (nm)	Lens Appearance	Vf(V) @ I <sub>F</sub> =20mA		IV(mcd) @ I <sub>F</sub> =20mA	Viewing Angle 2θ <sub>1/2</sub> (deg)
				Typ	Max	Typ	
BL-BGEKCUF2C4V	Yellow Green	566-576	White Diffused	2.0	2.6	150	55
	Yellow	586-594		2.0	2.6	450	
	Red	625-637		2.1	2.6	300	
BL-BGKB5JE2C4V	Green	510-530	White Diffused	3.2	3.6	1180	55
	Blue	460-475		3.2	3.6	340	
	Orange Red	615-628		2.0	2.6	300	
BL-BG6B4J73C4V	Green	515-535	Transparent	3.2	3.6	4500	40
	Blue	460-475		3.2	3.6	600	
	Orange Red	615-630		2.2	2.6	1200	

## BLINKING LAMP TYPE

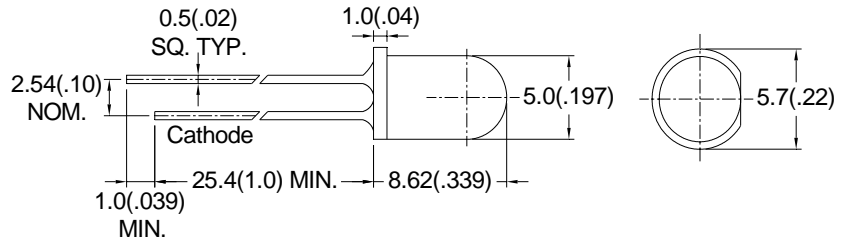

Unit: mm (inch)

Part No.	Emitted Color	$\lambda d$ (nm)	Lens Appearance	Pulse Rate(Hz) @VDD:5V			IV(mcd) @ $I_F=20mA$	Viewing Angle $2\theta_{1/2}$ (deg)
				Min	Typ	Max	Typ	
BB-BB5374	Blue	460-475	Transparent	2.0	2.4	2.8	90	40
BB-BGE374	Yellow Green	566-576	Transparent				30	40
BB-B4574	Red	625-638	Color Diffused				15	50
BB-BKC374	Yellow	586-594	Transparent				60	40

## RESISTOR LAMP TYPE

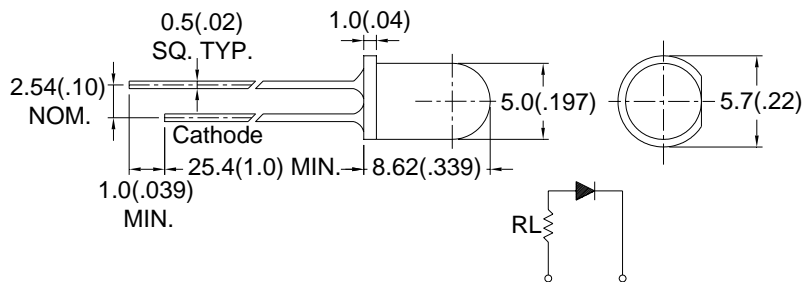

Unit: mm (inch)

Part No.	Emitted Color	$\lambda d$ (nm)	Lens Appearance	Operating Voltage (V)		Forward Current (mA)		IV(mcd) @ $I_F=20mA$	Viewing Angle $2\theta_{1/2}$ (deg)
				Typ	Max	Typ	Max	Typ	
BR-B2134-1-15V	Yellow Green	566-576	Color Diffused	-	15	11	14	45	40
BR-B3134-1-15V	Yellow	580-595	Color Diffused	-				13	40
BR-B4534-1-15V	Red	625-638	Color Diffused	-				60	40



## 8MM ROUND TYPE

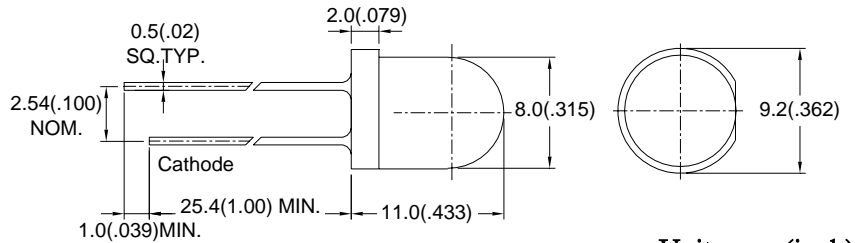
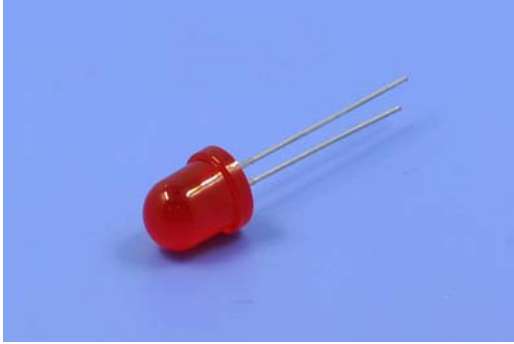

Unit: mm (inch)

Part No.	Emitted Color	$\lambda d$ (nm)	Lens Appearance	Vf(V) @ I <sub>F</sub> =20mA		IV(mcd) @ I <sub>F</sub> =20mA	Viewing Angle 2θ <sub>1/2</sub> (deg)
				Typ	Max	Typ	
BL-B2139	Yellow Green	566-576	Color Diffused	2.2	2.6	30	45
BL-B3139	Yellow	580-595	Color Diffused	2.1	2.6	33	45
BL-B4539	Red	625-638	Color Diffused	2.1	2.6	32	45
BL-BJE539	Orange Red	615-628	Color Diffused	2.0	2.6	350	45

## 10MM ROUND TYPE

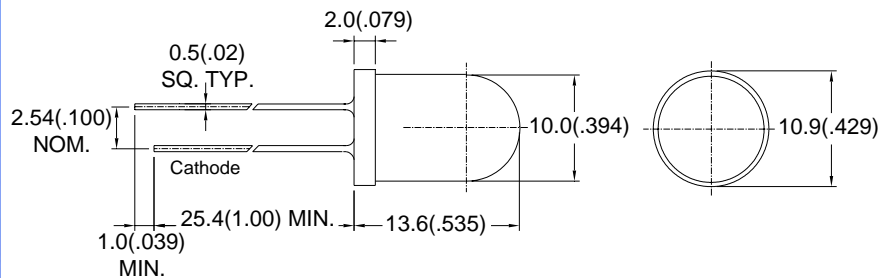
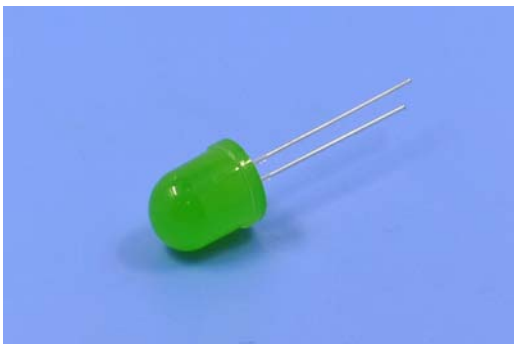

Unit: mm (inch)

Part No.	Emitted Color	$\lambda d$ (nm)	Lens Appearance	Vf(V) @ I <sub>F</sub> =20mA		IV(mcd) @ I <sub>F</sub> =20mA	Viewing Angle 2θ <sub>1/2</sub> (deg)
				Typ	Max	Typ	
BL-B2130A	Yellow Green	566-576	Color Diffused	2.2	2.6	6.0	50
BL-BGE130A	Yellow Green	566-576	Color Diffused	2.0	2.6	18	50
BL-B4530A	Red	625-638	Color Diffused	2.1	2.6	10	50

## RECTANGULAR

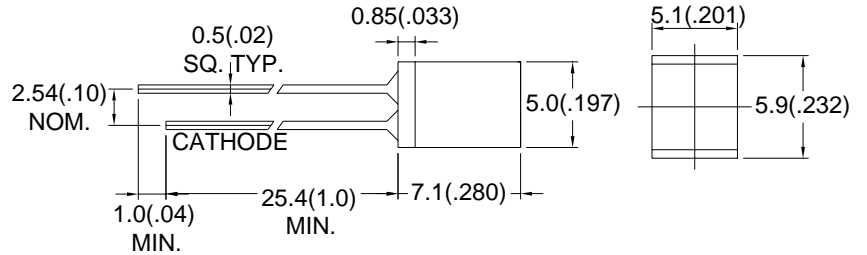
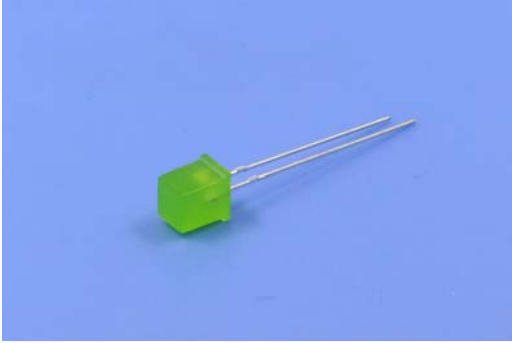

Unit: mm (inch)

Part No.	Emitted Color	$\lambda d$ (nm)	Lens Appearance	Vf(V) @ I <sub>F</sub> =20mA		IV(mcd) @ I <sub>F</sub> =20mA	Viewing Angle 2θ <sub>1/2</sub> (deg)
				Typ	Max	Typ	
BL-R2130	Yellow Green	566-576	Color Diffused	2.2	2.6	9.0	150
BL-R3130	Yellow	580-595	Color Diffused	2.1	2.6	6.0	150

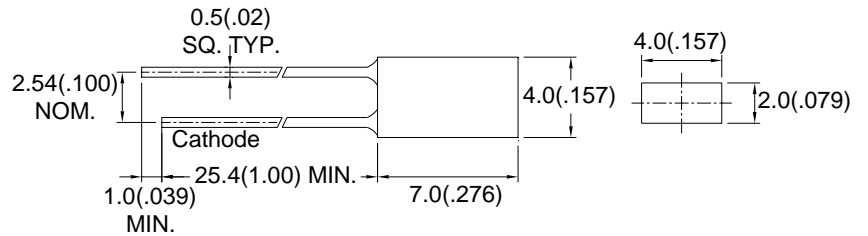

Unit: mm (inch)

Part No.	Emitted Color	$\lambda d$ (nm)	Lens Appearance	Vf(V) @ I <sub>F</sub> =20mA		IV(mcd) @ I <sub>F</sub> =20mA	Viewing Angle 2θ <sub>1/2</sub> (deg)
				Typ	Max	Typ	
BL-R2131	Yellow Green	566-576	Color Diffused	2.2	2.6	7.0	120
BL-R3131	Yellow	580-595	Color Diffused	2.1	2.6	7.0	120
BL-R4531	Red	625-638	Color Diffused	2.0	2.6	7.0	120

## RECTANGULAR

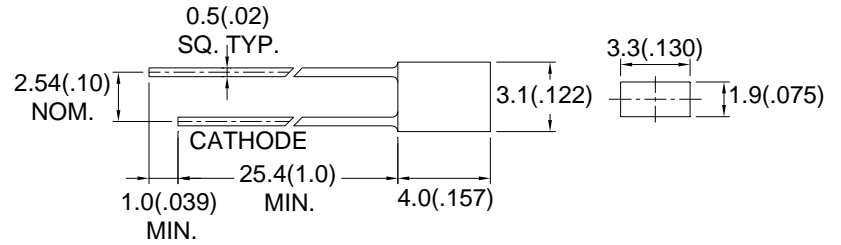
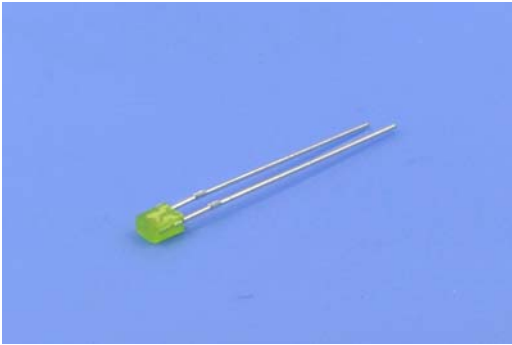

Unit: mm (inch)

Part No.	Emitted Color	$\lambda d$ (nm)	Lens Appearance	Vf(V) @ $I_F=20mA$		IV(mcd) @ $I_F=20mA$	Viewing Angle $2\theta_{1/2}$ (deg)
				Typ	Max	Typ	
BL-R2141F	Yellow Green	566-576	Color Diffused	2.2	2.6	20	100
BL-R31V1F	Yellow	580-595	Color Diffused	2.1	2.6	12	100
BL-RUB1V1F	Red	624-634	Color Diffused	2.0	2.6	80	100

## RECTANGULAR

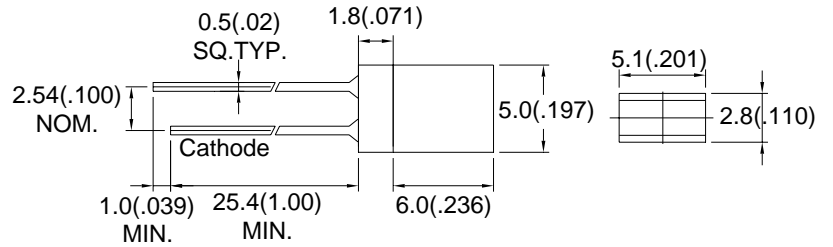

Unit: mm (inch)

Part No.	Emitted Color	$\lambda d$ (nm)	Lens Appearance	Vf(V) @ I <sub>F</sub> =20mA		IV(mcd) @ I <sub>F</sub> =20mA	Viewing Angle $2\theta_{1/2}$ (deg)
				Typ	Max	Typ	
BL-R2132	Yellow Green	566-576	Color Diffused	2.2	2.6	5.0	120
BL-RGE132	Yellow Green	566-576	Color Diffused	2.0	2.6	20	120
BL-R4532	Red	625-638	Color Diffused	2.0	2.6	5.0	120

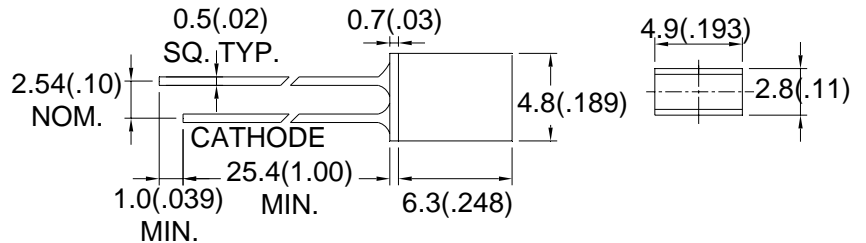

Unit: mm (inch)

Part No.	Emitted Color	$\lambda d$ (nm)	Lens Appearance	Vf(V) @ I <sub>F</sub> =20mA		IV(mcd) @ I <sub>F</sub> =20mA	Viewing Angle $2\theta_{1/2}$ (deg)
				Typ	Max	Typ	
BL-R2132B	Yellow Green	566-576	Color Diffused	2.2	2.6	5.0	120
BL-R3132B	Yellow	580-595	Color Diffused	2.1	2.6	4.0	120
BL-R4532B	Red	625-638	Color Diffused	2.0	2.6	5.0	120

## RECTANGULAR

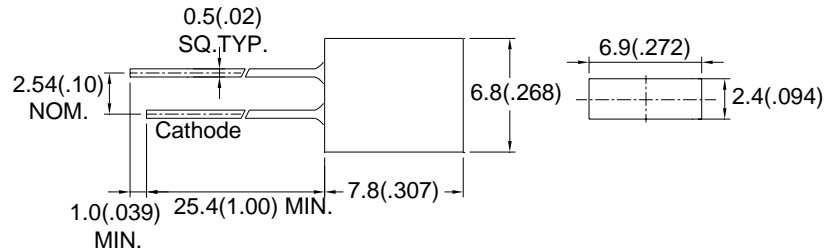
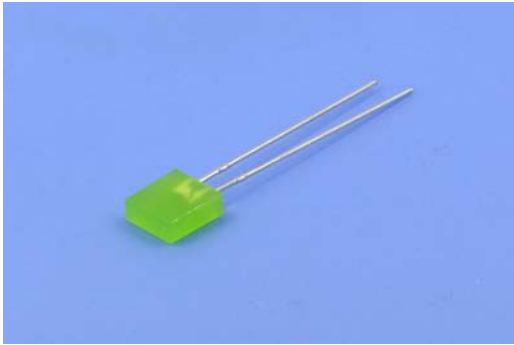

Unit: mm (inch)

Part No.	Emitted Color	$\lambda d$ (nm)	Lens Appearance	Vf(V) @ $I_F=20mA$		IV(mcd) @ $I_F=20mA$	Viewing Angle $2\theta_{1/2}$ (deg)
				Typ	Max	Typ	
BL-R2139A	Yellow Green	566-576	Color Diffused	2.2	2.6	4.5	130
BL-R3139A	Yellow	580-595	Color Diffused	2.1	2.6	4.0	130

## RECTANGULAR

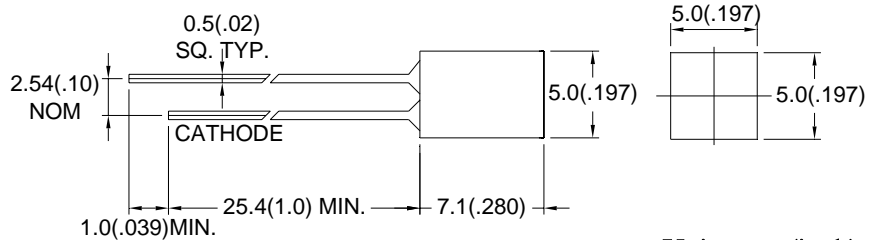
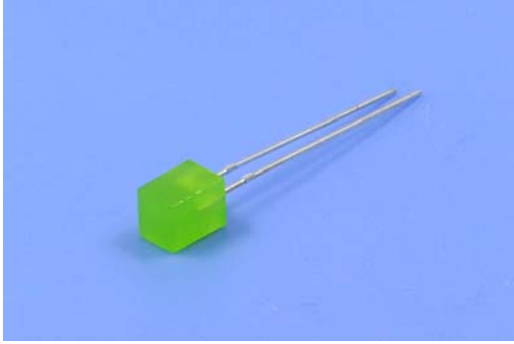

Unit: mm (inch)

Part No.	Emitted Color	$\lambda d$ (nm)	Lens Appearance	Vf(V) @ I <sub>F</sub> =20mA		IV(mcd) @ I <sub>F</sub> =20mA	Viewing Angle $2\theta_{1/2}$ (deg)
				Typ	Max	Typ	
BL-R2130N	Yellow Green	566-576	Color Diffused	2.2	2.6	5.0	150
BL-R3130N	Yellow	580-595	Color Diffused	2.1	2.6	6.0	150
BL-R4530N	Red	625-638	Color Diffused	2.0	2.6	8.0	150
BL-RUF130N	Red	625-637	Color Diffused	2.1	2.6	50	150

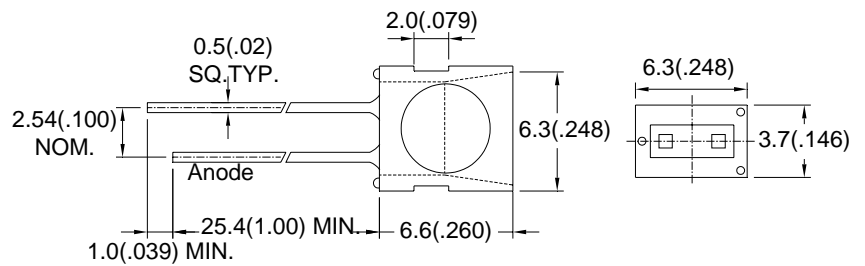
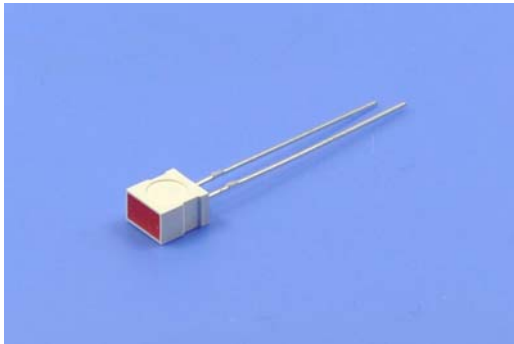

Unit: mm (inch)

Part No.	Emitted Color	$\lambda d$ (nm)	Lens Appearance	Vf(V) @ I <sub>F</sub> =20mA		IV(mcd) @ I <sub>F</sub> =20mA	Viewing Angle $2\theta_{1/2}$ (deg)
				Typ	Max	Typ	
BL-R213P	Yellow Green	566-576	Color Diffused	2.2	2.6	8.0	120
BL-R313P	Yellow	580-595	Color Diffused	2.1	2.6	7.0	120
BL-R453P	Red	625-638	Color Diffused	2.1	2.6	15	120



## RECTANGULAR

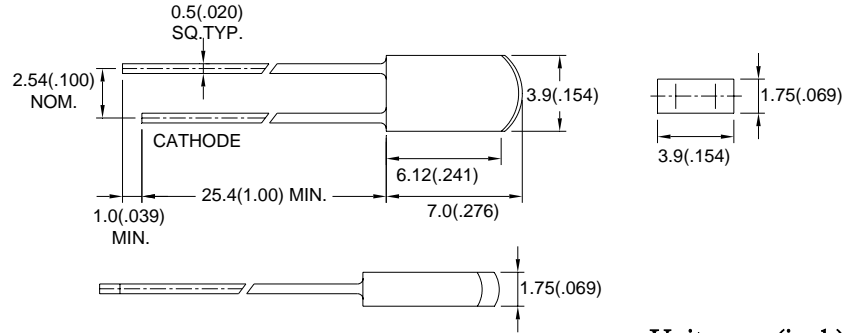

Unit: mm (inch)

Part No.	Emitted Color	$\lambda d$ (nm)	Lens Appearance	Vf(V) @ I <sub>F</sub> =20mA		IV(mcd) @ I <sub>F</sub> =20mA	Viewing Angle 2θ <sub>1/2</sub> (deg)
				Typ	Max	Typ	
BL-R2144T	Yellow Green	566-576	Color Diffused	2.2	2.6	25	80
BL-R3144T	Yellow	580-595	Color Diffused	2.1	2.6	25	80
BL-RUF144T	Red	625-637	Color Diffused	2.1	2.6	130	80

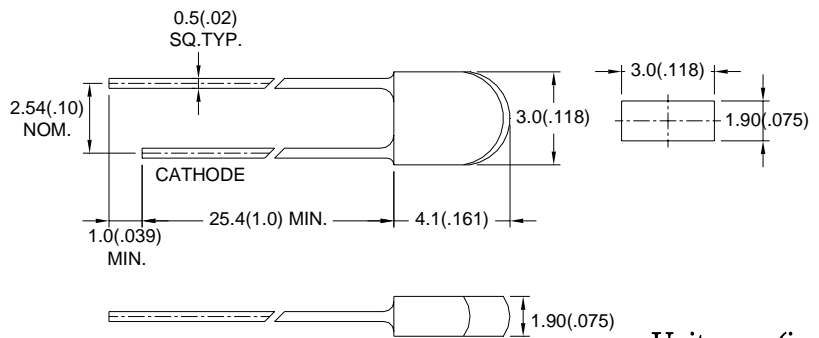

Unit: mm (inch)

Part No.	Emitted Color	$\lambda d$ (nm)	Lens Appearance	Vf(V) @ I <sub>F</sub> =20mA		IV(mcd) @ I <sub>F</sub> =20mA	Viewing Angle 2θ <sub>1/2</sub> (deg)
				Typ	Max	Typ	
BL-RBX3N1U	Blue	460-475	Transparent	3.2	3.6	550	60
BL-R2141U-HS-NP-LGT	Yellow Green	566-576	Color Diffused	2.2	2.6	15	130
BL-R31V1U-HS-NP	Yellow	580-595	Color Diffused	2.1	2.6	15	135

## CYLINDRICAL

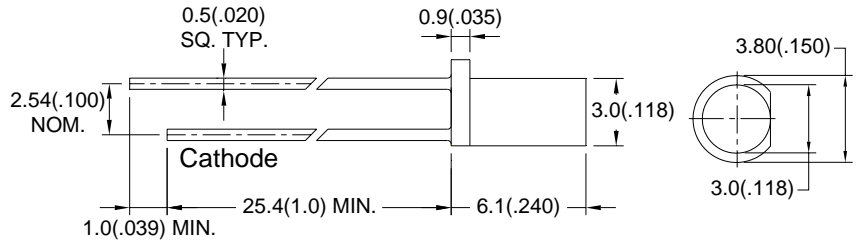

Unit: mm (inch)

Part No.	Emitted Color	$\lambda d$ (nm)	Lens Appearance	Vf(V) @ I <sub>F</sub> =20mA		IV(mcd) @ I <sub>F</sub> =20mA	Viewing Angle 2θ <sub>1/2</sub> (deg)
				Typ	Max	Typ	
BL-CB41V2	Blue	460-475	Color Diffused	3.2	3.6	40	130
BL-C2142	Yellow Green	566-576	Color Diffused	2.2	2.6	7.0	130
BL-C3142	Yellow	580-595	Color Diffused	2.1	2.6	6.5	130

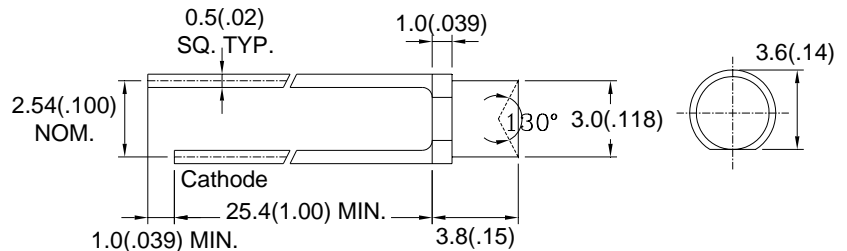

Unit: mm (inch)

Part No.	Emitted Color	$\lambda d$ (nm)	Lens Appearance	Vf(V) @ I <sub>F</sub> =20mA		IV(mcd) @ I <sub>F</sub> =20mA	Viewing Angle 2θ <sub>1/2</sub> (deg)
				Typ	Max	Typ	
BL-CGE3V5	Yellow Green	566-576	Transparent	2.0	2.6	30	120
BL-CKC3V5	Yellow	584-594	Transparent	2.0	2.6	110	120
BL-CUB345	Red	624-634	Transparent	2.0	2.6	60	120

# TOWER

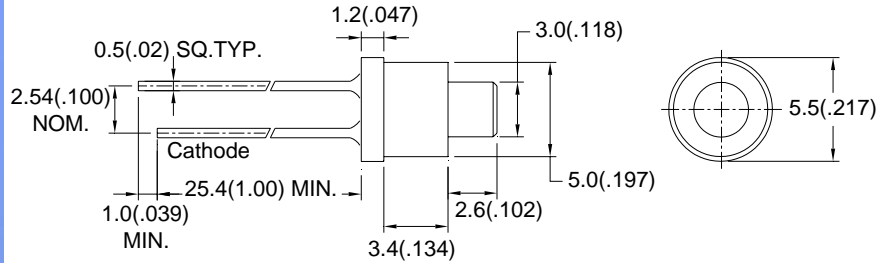

Unit: mm (inch)

Part No.	Emitted Color	$\lambda d$ (nm)	Lens Appearance	Vf(V) @ I <sub>F</sub> =20mA		IV(mcd) @ I <sub>F</sub> =20mA	Viewing Angle 2θ <sub>1/2</sub> (deg)
				Typ	Max	Typ	
BL-SB52V2	Blue	460-475	White Diffused	3.2	3.6	55	100
BL-SGE132	Yellow Green	566-576	Color Diffused	2.0	2.6	13	100
BL-SKC132	Yellow	586-594	Color Diffused	2.0	2.6	60	100
BL-S4132	Red	625-638	Color Diffused	2.0	2.6	4.5	100

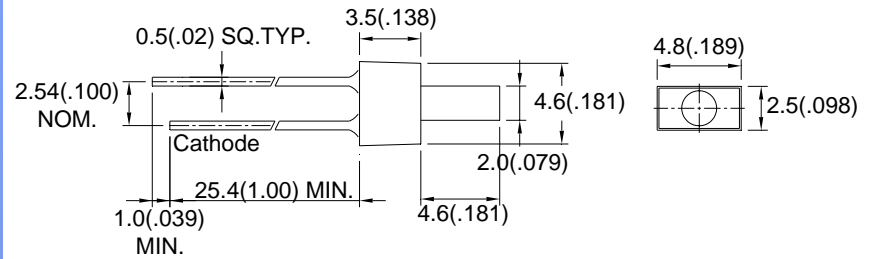

Unit: mm (inch)

Part No.	Emitted Color	$\lambda d$ (nm)	Lens Appearance	Vf(V) @ I <sub>F</sub> =20mA		IV(mcd) @ I <sub>F</sub> =20mA	Viewing Angle 2θ <sub>1/2</sub> (deg)
				Typ	Max	Typ	
BL-SG63V6	Green	515-535	Transparent	3.2	3.6	2000	90
BL-S3136	Yellow	580-595	Color Diffused	2.1	2.6	6.0	70
BL-S4136	Red	625-638	Color Diffused	2.0	2.6	6.5	70

## TRIANGULAR

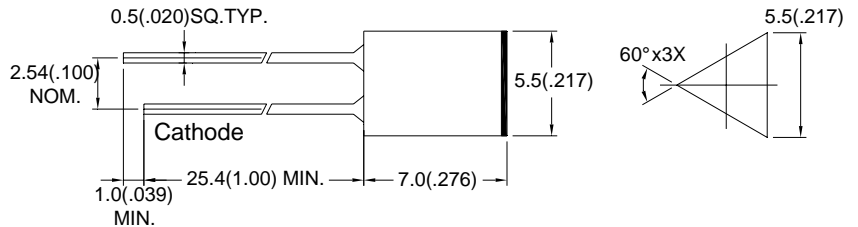

Unit: mm (inch)

Part No.	Emitted Color	$\lambda d$ (nm)	Lens Appearance	Vf(V) @ I <sub>F</sub> =20mA		IV(mcd) @ I <sub>F</sub> =20mA	Viewing Angle $2\theta_{1/2}$ (deg)
				Typ	Max	Typ	
BL-T3141-T	Yellow	580-595	Color Diffused	2.1	2.6	10	120
BL-T4531-T	Red	625-638	Color Diffused	2.0	2.6	6.5	120

## ELLIPSE

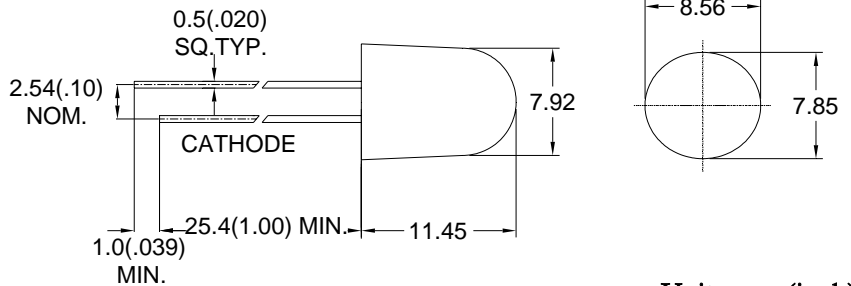

Unit: mm (inch)

Part No.	Emitted Color	$\lambda d$ (nm)	Lens Appearance	Vf(V) @ I <sub>F</sub> =20mA		IV(mcd) @ I <sub>F</sub> =20mA	Viewing Angle $2\theta_{1/2}$ (deg)
				Typ	Max	Typ	
BTL-WKT3R4J-1-LS	Yellow	586-594	Transparent	2.0	2.6	15000	30(X-X) 15(Y-Y)
BTL-WJL3R4J-1-LS	Orange Red	620-630	Transparent	2.1	2.6	20000	45(X-X) 20(Y-Y)
BTL-WJU3R4J-1-LS	Orange Red	620-630	Transparent	2.0	2.6	15000	30(X-X) 15(Y-Y)

## HOLDER ASSEMBLY

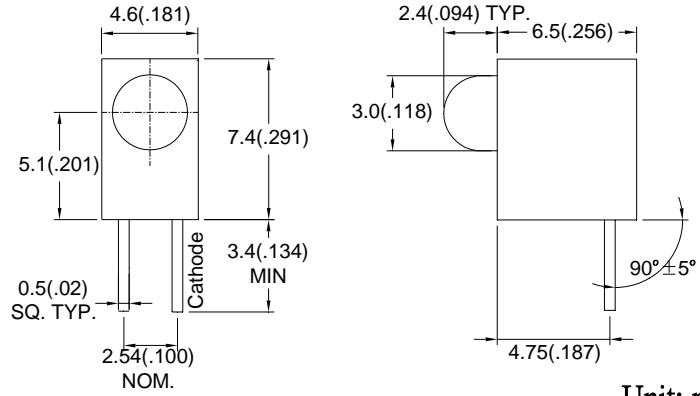
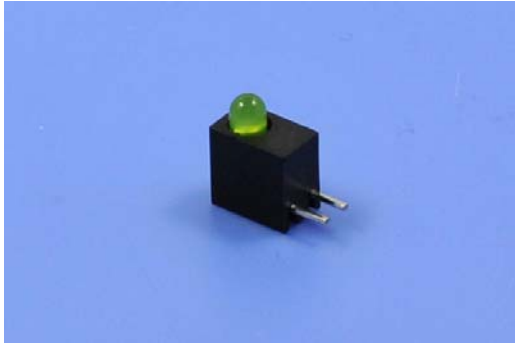

Unit: mm (inch)

Part No.	Emitted Color	$\lambda d$ (nm)	Lens Appearance	Vf(V) @ I <sub>F</sub> =20mA		IV(mcd) @ I <sub>F</sub> =20mA	Viewing Angle 2θ <sub>1/2</sub> (deg)
				Typ	Max	Typ	
BL-C9/G-41K	Yellow Green	566-576	Color Diffused	2.2	2.6	35	45
BL-C9/I-41K	Red	625-638	Color Diffused	2.0	2.6	35	35
BL-C9/S-41K	Red	638-648	Color Diffused	1.8	2.6	50	35
BL-C9/Y-41K	Yellow	580-594	Color Diffused	2.1	2.6	45	35
BL-C9/B5-V1K	Blue	460-475	Color Diffused	3.2	3.6	340	35

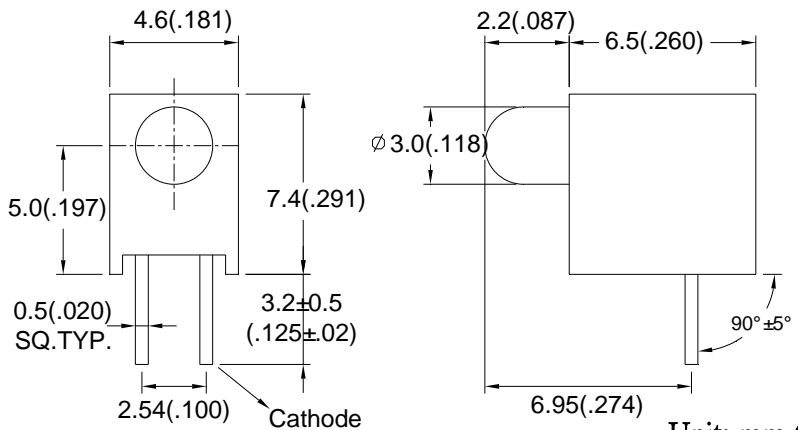
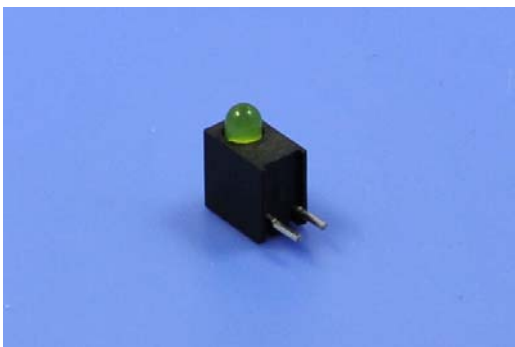

Unit: mm (inch)

Part No.	Emitted Color	$\lambda d$ (nm)	Lens Appearance	Vf(V) @ I <sub>F</sub> =20mA		IV(mcd) @ I <sub>F</sub> =20mA	Viewing Angle 2θ <sub>1/2</sub> (deg)
				Typ	Max	Typ	
BL-C7C/G-V1J-AA-LC3.2-T10	Yellow Green	566-576	Color Diffused	2.0	2.5	20	35
BL-C7C/GJC-V1J-AA-LC3.2	Yellow Green	566-576	Transparent	2.0	2.6	690	30

## HOLDER ASSEMBLY

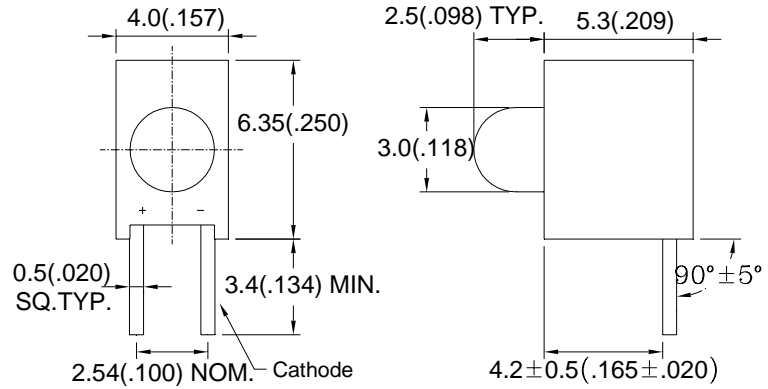
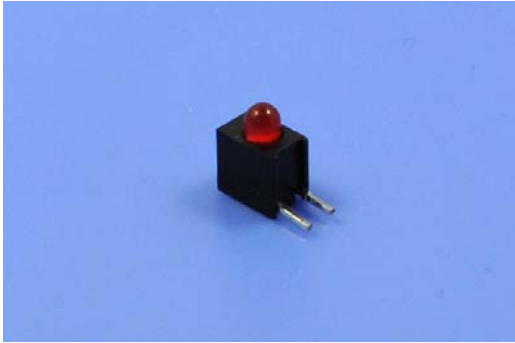

Unit: mm (inch)

Part No.	Emitted Color	$\lambda d$ (nm)	Lens Appearance	Vf(V) @ I <sub>F</sub> =20mA		IV(mcd) @ I <sub>F</sub> =20mA	Viewing Angle 2θ <sub>1/2</sub> (deg)
				Typ	Max	Typ	
BL-C32A/G-41K	Yellow Green	566-576	Color Diffused	2.2	2.6	35	45
BL-C32A/I-41K	Red	625-638	Color Diffused	2.0	2.6	35	45
BL-C32A/Y-41K	Yellow	580-594	Color Diffused	2.1	2.6	35	45

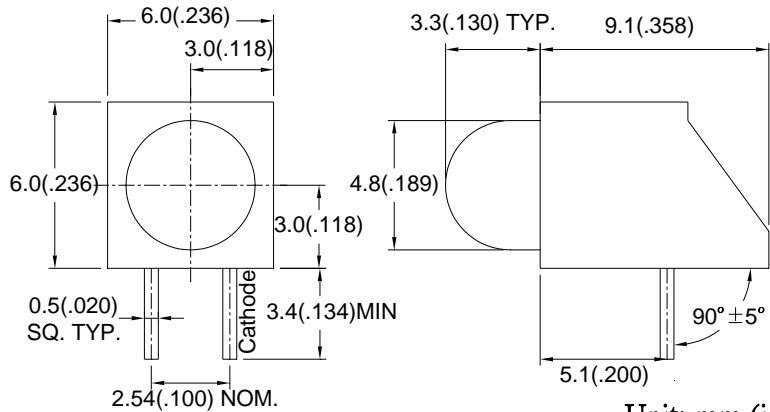

Unit: mm (inch)

Part No.	Emitted Color	$\lambda d$ (nm)	Lens Appearance	Vf(V) @ I <sub>F</sub> =20mA		IV(mcd) @ I <sub>F</sub> =20mA	Viewing Angle 2θ <sub>1/2</sub> (deg)
				Typ	Max	Typ	
BL-C105D/G-33N	Yellow Green	566-576	Color Diffused	2.2	2.6	30	40
BL-C105D/H-33N	Red	638-648	Color Transparent	2.0	2.6	30	30
BL-C105D/Y-33N	Yellow	580-594	Color Diffused	2.1	2.6	30	40



## HOLDER ASSEMBLY

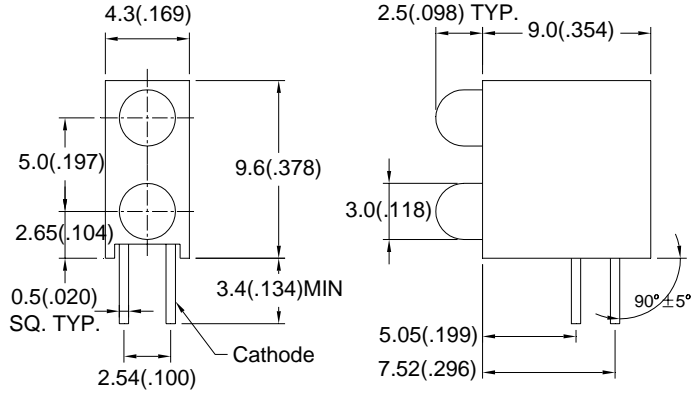
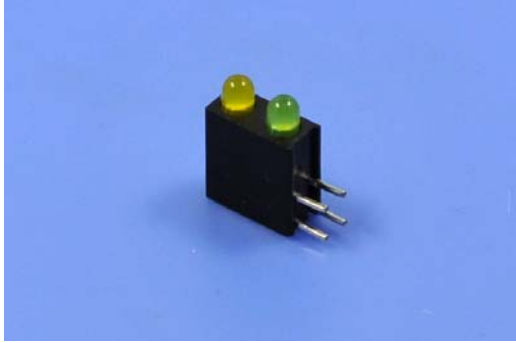

Unit: mm (inch)

Part No.	Emitted Color	$\lambda d$ (nm)	Lens Appearance	Vf(V) @ I <sub>F</sub> =20mA		IV(mcd) @ I <sub>F</sub> =20mA	Viewing Angle 2θ <sub>1/2</sub> (deg)
				Typ	Max	Typ	
BL-C34/YG-41K	Yellow	580-595	Color Diffused	2.1	2.6	50	45
	Yellow Green	566-576		2.2	2.6	35	
BL-C34/2EGW-71K	Red	625-638	White Diffused	2.0	2.6	8	40
	Yellow Green	566-576		2.2	2.6	10	

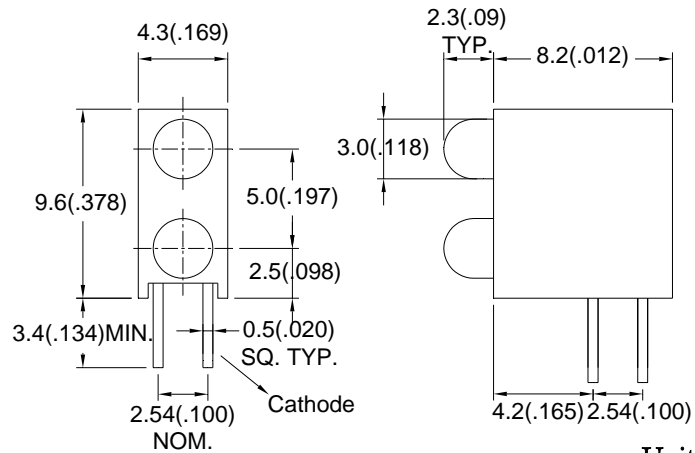
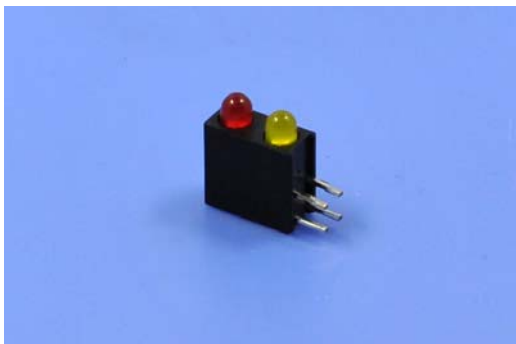

Unit: mm (inch)

Part No.	Emitted Color	$\lambda d$ (nm)	Lens Appearance	Vf(V) @ I <sub>F</sub> =20mA		IV(mcd) @ I <sub>F</sub> =20mA	Viewing Angle 2θ <sub>1/2</sub> (deg)
				Typ	Max	Typ	
BL-C7H/IY-V1J-AA	Red	625-638	Color Diffused	2.1	2.6	35	35
	Yellow	580-595		2.1	2.6	45	
BL-C7H/NG-V1J-AA	Yellow Green	566-576	Color Diffused	2.2	2.6	40	35

## HOLDER ASSEMBLY

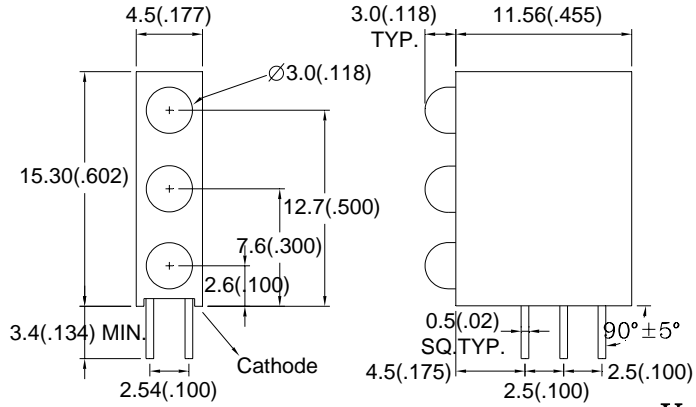
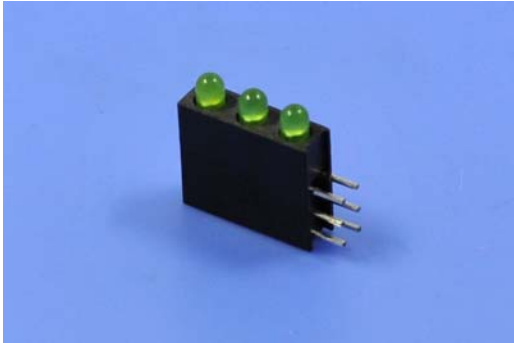

Unit: mm (inch)

Part No.	Emitted Color	$\lambda d$ (nm)	Lens Appearance	Vf(V) @ I <sub>F</sub> =20mA		IV(mcd) @ I <sub>F</sub> =20mA	Viewing Angle 2θ <sub>1/2</sub> (deg)
				Typ	Max	Typ	
BL-C34M/3G-41J	Yellow Green	566-576	Color Diffused	2.1	2.6	40	30
BL-C34M/HGY-41J	Red	650	Color Diffused	2.3	2.6	3.5	35
	Yellow Green	566-576		2.1	2.6	40	
	Yellow	580-595		2.1	2.6	30	
BL-C34M/3Y-41J	Yellow	580-595	Color Diffused	2.1	2.6	45	35

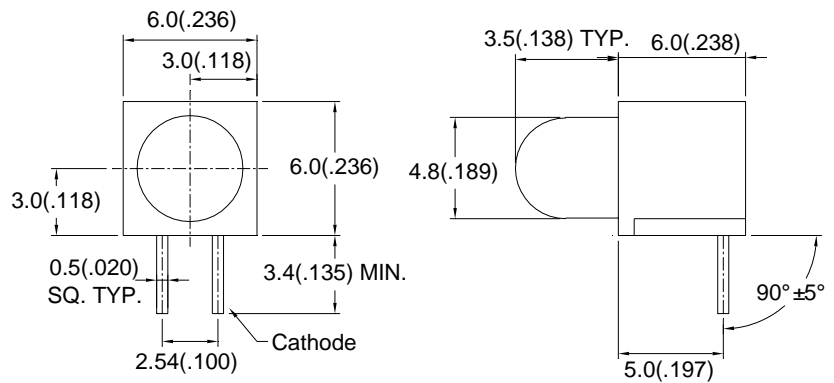
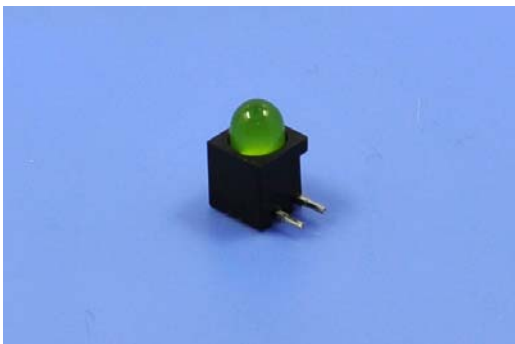

Unit: mm (inch)

Part No.	Emitted Color	$\lambda d$ (nm)	Lens Appearance	Vf(V) @ I <sub>F</sub> =20mA		IV(mcd) @ I <sub>F</sub> =20mA	Viewing Angle 2θ <sub>1/2</sub> (deg)
				Typ	Max	Typ	
BL-C61/G-33N	Yellow Green	566-576	Color Diffused	2.2	2.6	45	40
BL-C61/H-33N	Red	650	Color Diffused	2.3	2.6	3.0	40

## HOLDER ASSEMBLY

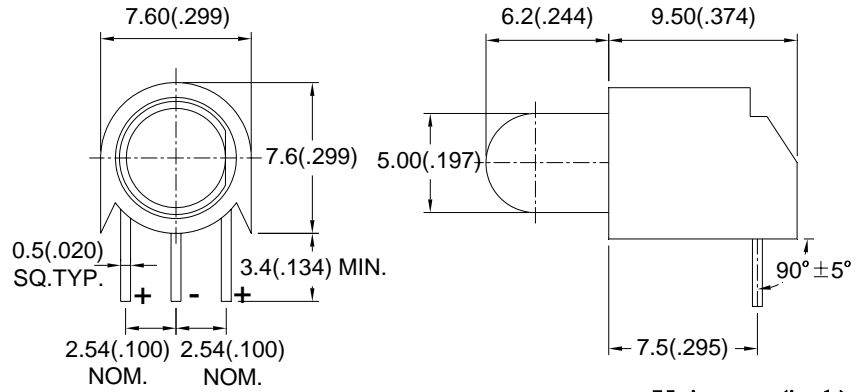

Unit: mm (inch)

Part No.	Emitted Color	$\lambda d$ (nm)	Lens Appearance	Vf(V) @ I <sub>F</sub> =20mA		IV(mcd) @ I <sub>F</sub> =20mA	Viewing Angle $2\theta_{1/2}$ (deg)
				Typ	Max	Typ	
BL-C36/EGW-04	Red	625-638	White Diffused	2.1	2.6	50	50
	Yellow Green	566-576		2.2	2.6	70	
BL-C36/YGW-04	Yellow	580-595	White Diffused	2.1	2.6	70	50
	Yellow Green	566-576		2.2	2.6	70	

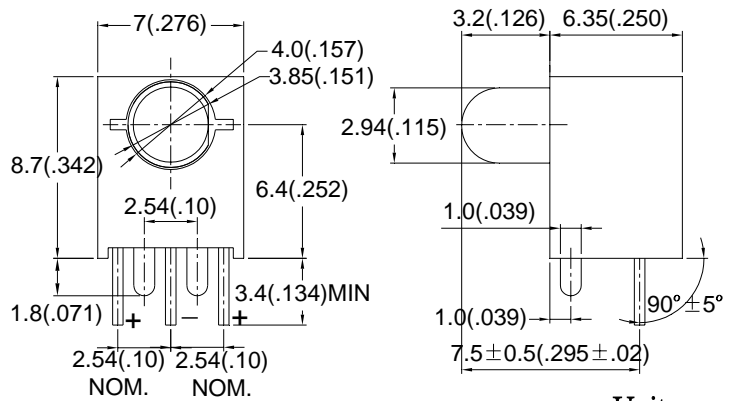
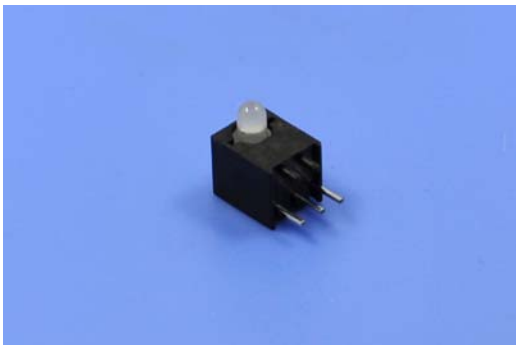

Unit: mm (inch)

Part No.	Emitted Color	$\lambda d$ (nm)	Lens Appearance	Vf(V) @ I <sub>F</sub> =20mA		IV(mcd) @ I <sub>F</sub> =20mA	Viewing Angle $2\theta_{1/2}$ (deg)
				Typ	Max	Typ	
BL-C36A/UBB3W-01G-NP-26F	Red	627-637	White Diffused	2.0	2.6	95	60
	Blue	460-475		3.2	3.6	180	
BL-C36A/JDGEW-01G	Orange Red	620-630	White Diffused	2.0	2.6	230	50
	Yellow Green	566-576		2.2	2.6	200	

## HOLDER ASSEMBLY

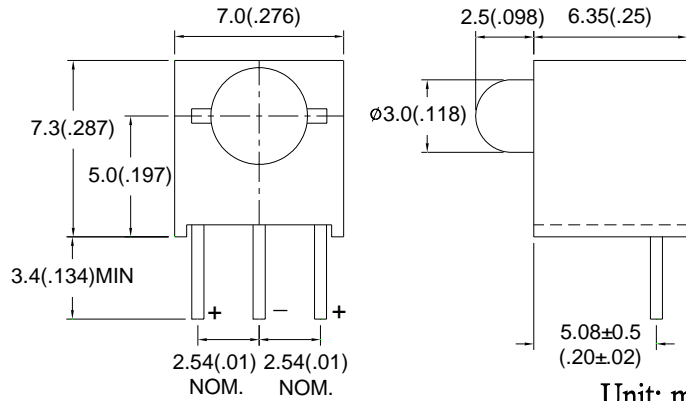
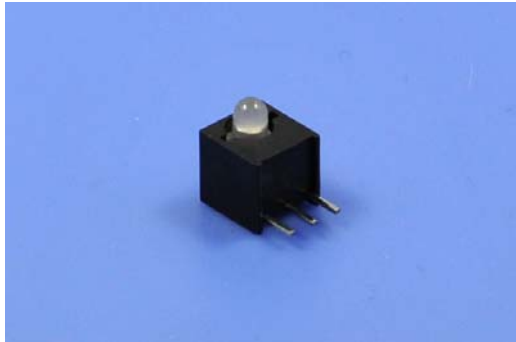

Unit: mm (inch)

Part No.	Emitted Color	$\lambda d$ (nm)	Lens Appearance	Vf(V) @ I <sub>F</sub> =20mA		IV(mcd) @ I <sub>F</sub> =20mA	Viewing Angle 2θ <sub>1/2</sub> (deg)
				Typ	Max	Typ	
BL-C9V/GEUBW-01G	Yellow Green	566-576	White Diffused	2.0	2.6	225	40
	Red	625-637		2.0	2.6	400	

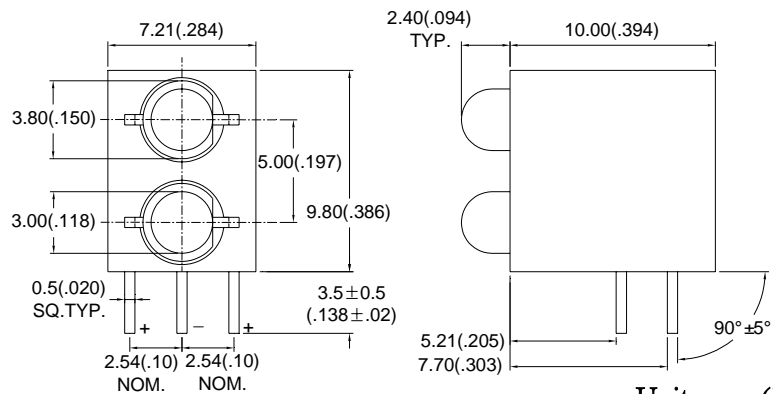

Unit: mm (inch)

Part No.	Emitted Color	$\lambda d$ (nm)	Lens Appearance	Vf(V) @ I <sub>F</sub> =20mA		IV(mcd) @ I <sub>F</sub> =20mA	Viewing Angle 2θ <sub>1/2</sub> (deg)
				Typ	Max	Typ	
BL-C29E/2GYW-01-LC3.5	Yellow Green	566-576	White Diffused	2.2	2.6	35	40
	Yellow	580-594		2.2	2.6	30	
BL-C29E/2EGW-01-LC3.5	Red	617-638	White Diffused	2.0	2.6	35	40
	Yellow Green	566-576		2.2	2.6	35	

## HOLDER ASSEMBLY

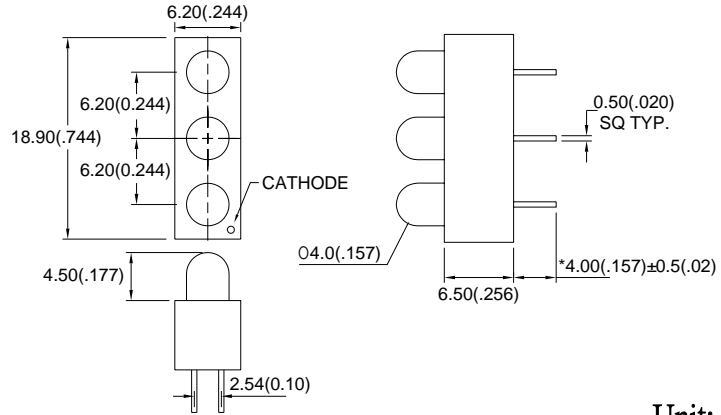
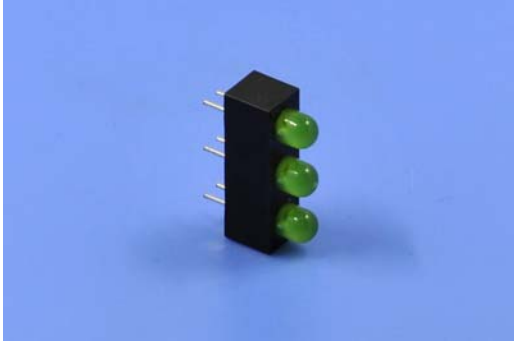

Unit: mm (inch)

Part No.	Emitted Color	$\lambda d$ (nm)	Lens Appearance	Vf(V) @ I <sub>F</sub> =20mA		IV(mcd) @ I <sub>F</sub> =20mA	Viewing Angle 2θ 1/2 (deg)
				Typ	Max	Typ	
BL-C35N/3G-32-LC4	Yellow Green	566-576	Color Diffused	2.2	2.6	35	55
BL-C35N/3S-32-LC4	Red	638-648	Color Diffused	2.0	2.6	30	55

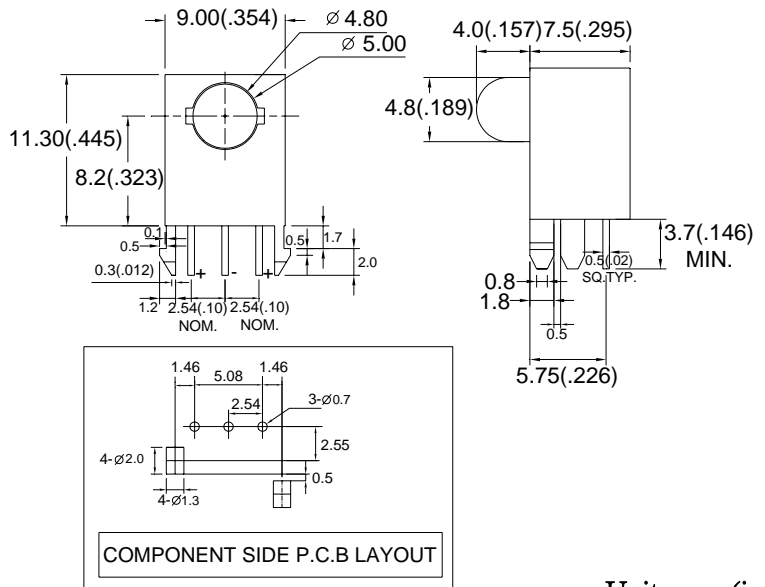

Unit: mm (inch)

Part No.	Emitted Color	$\lambda d$ (nm)	Lens Appearance	Vf(V) @ I <sub>F</sub> =20mA		IV(mcd) @ I <sub>F</sub> =20mA	Viewing Angle 2θ 1/2 (deg)
				Typ	Max	Typ	
BL-C52C/GJJEC-03N	Yellow Green Orange Red	566-576 615-628	Transparent	2.1	2.6	1500	35
				2.0	2.6	1000	

## HOLDER ASSEMBLY

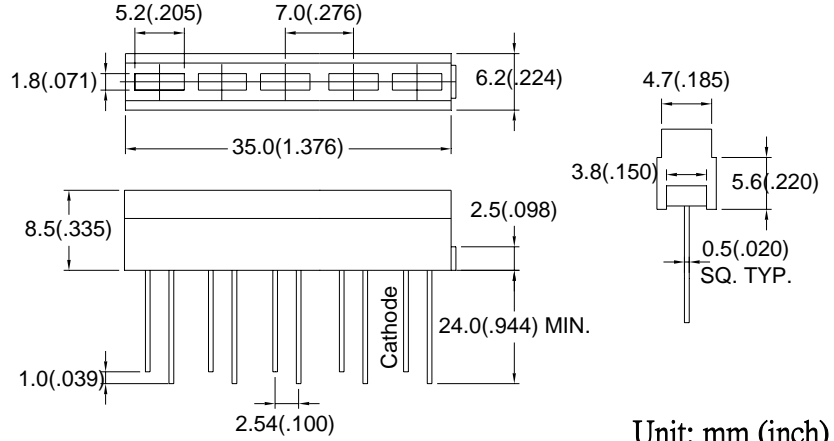

Unit: mm (inch)

Part No.	Emitted Color	$\lambda d$ (nm)	Lens Appearance	Vf(V) @ I <sub>F</sub> =20mA		IV(mcd) @ I <sub>F</sub> =20mA	Viewing Angle 2θ <sub>1/2</sub> (deg)
				Typ	Max	Typ	
BL-C55/5G-38-P	Yellow Green	566-576	Color Diffused	2.2	2.6	5	130
BL-C55/4G1H-38	Yellow Green	566-576	Color Diffused	2.2	2.6	5.0	130
	Red	650		2.3	2.6	0.4	

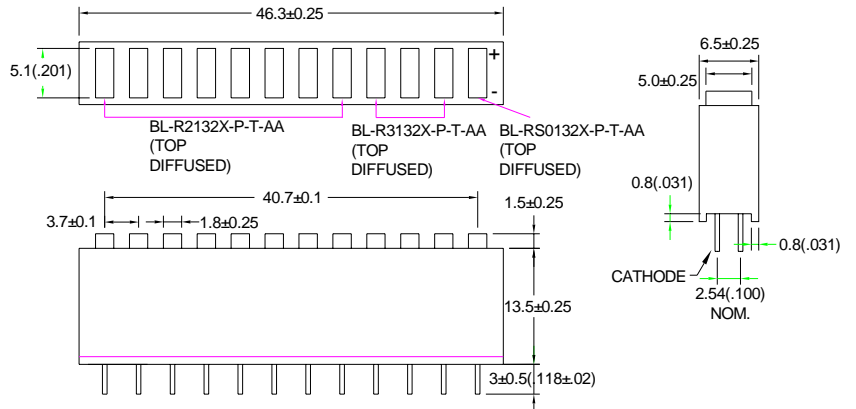
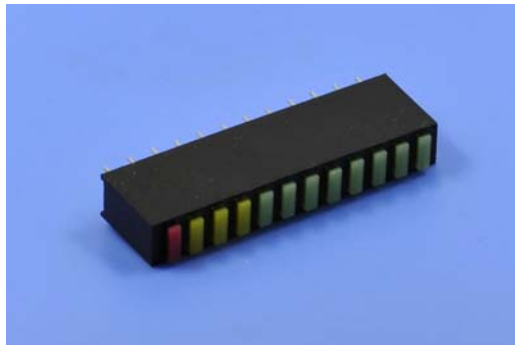

Unit: mm (inch)

Part No.	Emitted Color	$\lambda d$ (nm)	Lens Appearance	Vf(V) @ I <sub>F</sub> =20mA		IV(mcd) @ I <sub>F</sub> =20mA	Viewing Angle 2θ <sub>1/2</sub> (deg)
				Typ	Max	Typ	
BL-C22N-B	Yellow Green	566-576	Color Diffused	2.2	2.6	5.0	135
	Yellow	580-594		2.1	2.6	6.0	
	Red	638-648		1.8	2.6	3.0	

## HOLDER ASSEMBLY

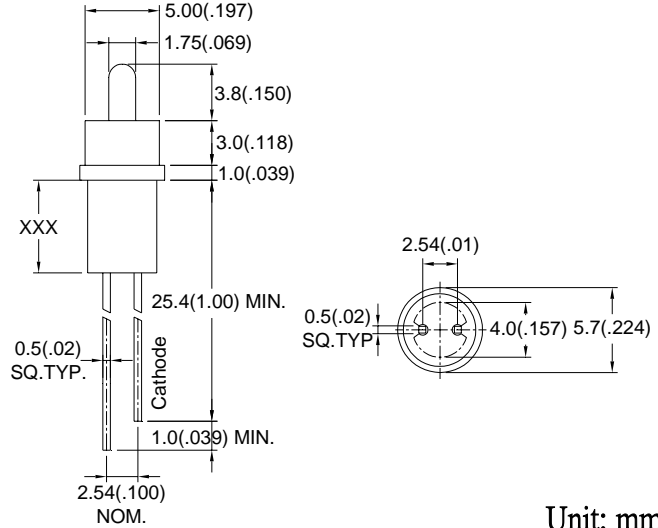

Unit: mm (inch)

Part No.	Emitted Color	$\lambda d$ (nm)	Lens Appearance	Vf(V) @ I <sub>F</sub> =20mA		IV(mcd) @ I <sub>F</sub> =20mA	Viewing Angle 2θ <sub>1/2</sub> (deg)
				Typ	Max	Typ	
BL-C38I/G-S31-XXX	Yellow Green	566-576	Color Diffused	2.2	2.6	15	75
BL-C38I/I-S31-XXX	Red	617-638	Color Diffused	2.0	2.6	15	75

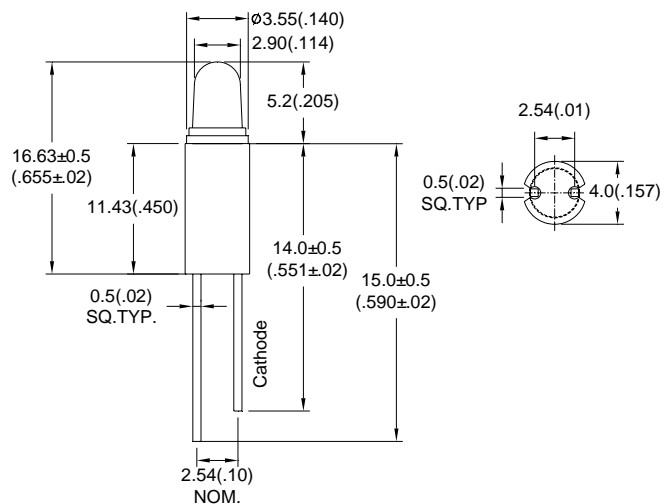

Unit: mm (inch)

Part No.	Emitted Color	$\lambda d$ (nm)	Lens Appearance	Vf(V) @ I <sub>F</sub> =20mA		IV(mcd) @ I <sub>F</sub> =20mA	Viewing Angle 2θ <sub>1/2</sub> (deg)
				Typ	Max	Typ	
BL-C38I/I-41T-450-LC14/15	Red	617-638	Color Diffused	2.0	2.6	35	35
BL-C38I/Y-41T-450-LC14/15	Yellow	580-595	Color Diffused	2.1	2.6	30	35