

Quick Splice Connectors

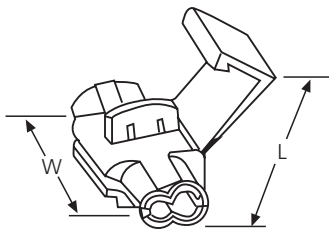

Technical Table

Code	Wire Range (mm <sup>2</sup> )	Colour	Dimensions	
			W	L
1QS	0,25		20,0	27,0
2QS	2,0		20,0	27,0
3QS	5,5		20,5	34,5

Closed End Connectors

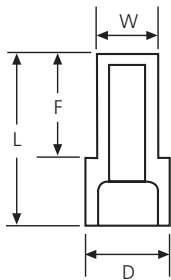

Technical Table

Code	(mm <sup>2</sup> )	Dimensions			
		W	L	F	D
CE1	1,25	5,3	21,0	8,0	9,8
CE2	2	6,0	21,0	9,0	10,0

Boot Lace Ferrules

E - Insulated

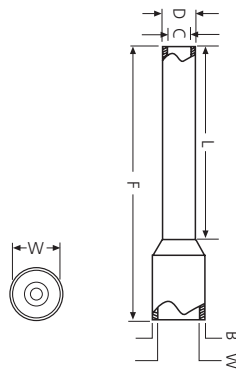

Technical Table

Code	Dimensions (mm)						Wire Range Insulation	
	L	F	W	B	C	D	(mm <sup>2</sup> )	Colour
E0208	8.0	12.4	1.9	4.4	0.8	1.1	0.25	
E0308	8.0	12.4	1.9	4.4	0.8	1.1	0.34	
E0510	10.0	16.0	2.6	6.0	1.0	1.3	0.5	White
E0710	10.0	16.3	3.0	6.3	1.2	1.5	0.75	
E01010	10.0	16.3	3.0	6.3	1.4	1.7	1.0	
E01510	10.0	16.4	3.5	6.3	2.0	1.7	1.5	
E02512	12.0	19.4	4.0	7.4	2.3	2.6	2.5	
E4012	12.0	19.4	4.5	7.4	2.8	3.2	4.0	
E6012	12.0	20.5	6.0	8.5	3.5	3.9	6.0	
E10012	12.0	20.8	7.5	8.8	4.5	4.9	10.0	
E16018	18.0	28.0	8.7	10.0	5.8	6.2	16.0	
TE0508	14.5	8.0	5.0	3.6	1.5	1.8	0.5	White
TE0708	14.7	8.0	5.5	3.5	1.8	2.1	0.75	
TE1010	17.1	10.0	5.5	4.0	2.0	2.3	1.0	
TE1512	19.5	12.0	6.4	4.2	2.3	2.6	1.5	
TE2513	21.5	13.0	8.0	5.0	2.9	3.3	2.5	
TE4012	23.1	12.0	8.8	5.7	3.8	4.2	4.0	
TE6014	26.1	14.0	9.5	6.8	4.9	5.3	6.0	
TE10014	26.6	14.0	12.1	8.0	6.5	6.9	10.0	
TE16014	31.3	14.0	19.0	10.5	8.3	8.7	16.0	

TE - Twin Entry Insulated

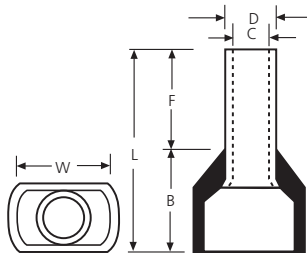

Technical Table

Code	Dimensions (mm)				Wire Range (mm <sup>2</sup> )
	L	F	W	C	
EN0506	6.0	1.3	1.7	1.0	0.5
EN0710	10.0	1.5	1.9	1.2	0.75
EN1010	10.0	1.7	2.2	1.4	1.0
EN1510	10.0	2.0	2.5	1.7	1.5
EN2512	12.0	2.6	3.3	2.3	2.5
EN4012	12.0	3.2	3.9	2.8	4.0
EN6012	12.0	3.9	4.7	3.5	6.0
EN10012	12.0	4.9	5.8	4.5	10.0
EN16018	18.0	6.2	7.2	5.8	16.0

EN - Uninsulated

