

Product Specifications

(Part number system for led lamp) CZ181530

CZ502WWC (φ5MM clear round lens warm white light emission long legs)

(Package Dimensions) (Unit) : mm

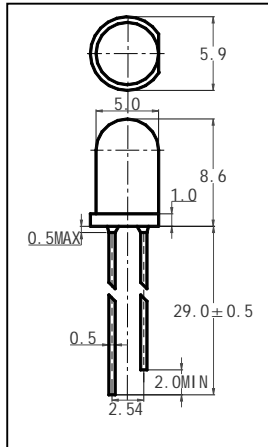

(CHIP)	
(Material)	InGaAlP
(Emission)	Warm white
(Body)	
(Material)	Epoxy resin
(Color)	Transparent

(Absolute Maximum Ratings) (Ta=25°C)

(Parameter)	(Symbol)	(Value)	(Unit)
(Max Power Dissipation)	P_M	80	mW
(Max Continuous Forward Current)	I_{FM}	30	mA
(Max Reverse Voltage)	V_{RM}	5	V
(Peak Forward Current)	I_{FP}	75	mA
(Lead Soldering Temperature/Time)	T_{SOL}	240/≤3S	°C/S
(Operating Temperature Range)	T_{OPR}	-25~+85	°C
(Storage Temperature Range)	T_{STR}	-30~+100	°C

(Initial Electrical Optical Characteristics)

(Parameter)	Symbol	Min.	Typ.	Max.	Unit	Condition
(Luminous Intensity)	I_v	12000	/	14000	mcd	I_F=20mA
(Viewing Angle)	2θ_{1/2}	/	15	/	deg	I_F=20mA
(Peak Wave Length)	λ_p	/	/	/	nm	I_F=20mA
(Colour Temperature)	λ_d	2600	2800	3000	K	I_F=20mA
(Spectral Width at half height)	Δλ	/	30	/	nm	I_F=20mA
(Forward Voltage)	V_F	3.0	3.2	3.4	V	I_F=20mA
(Reverse Current)	I_R	/	/	≤30	μA	V_R=5V