

M5750
TNC male clamp type gold-pin
(RG58U/59U)

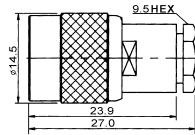

M5759
Right angle TNC male to TNC female gold-pin

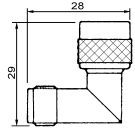

M5751
TNC male crimp type gold-pin
(RG58U/59U)

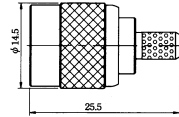

M5760
Double TNC female gold-pin

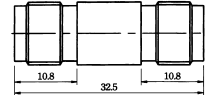

M5752
TNC male twist on type gold-pin
(RG58U/59U)

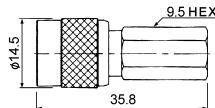

M5761
Double TNC female bulkhead gold-pin

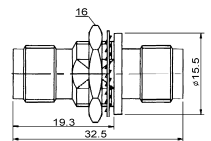

M5753
TNC female twist on type gold-pin
(RG58U/59U)

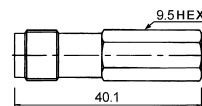

M576110
T-type TNC male to double TNC female gold-pin

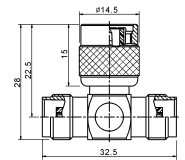

M5754
TNC female bulkhead receptacle gold-pin

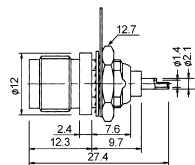

M576112
T-type triple TNC female gold-pin

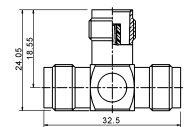

M5755
TNC female bulkhead crimp type gold-pin
(RG58U/59U)

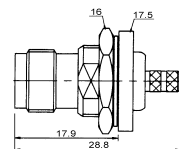
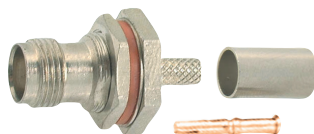

M5762
TNC female to BNC male gold-pin

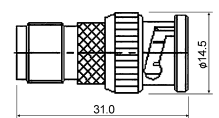

M5756
TNC female crimp type gold-pin
(RG58U/59U)

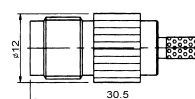

M576205
TNC male to BNC male gold-pin

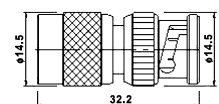

M5757
TNC male to BNC female gold-pin

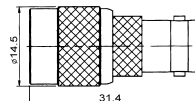

M5765
TNC female clamp type gold-pin
(RG58U/59U)

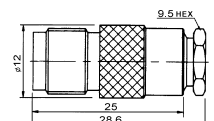

M5758
TNC male to UHF female gold-pin

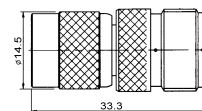

M5766
TNC female chassis mount gold-pin

