

SPECIFICATIONS

Current Rating: 3A AC, DC
 Contact Resistance: 20m Ω Max
 Insulation Resistance: 1000M Ω Min
 Withstanding Voltage: 1000V AC for 1 minute
 Temperature Range: -40°C to +105°C

MATERIAL

Contact: Brass
 Insulator: PBT, UL94V-0

ORDER INFORMATION

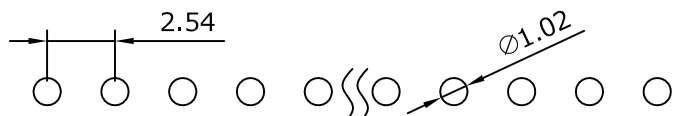
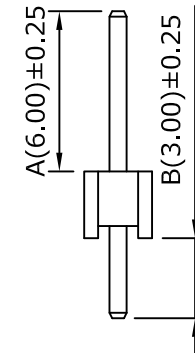
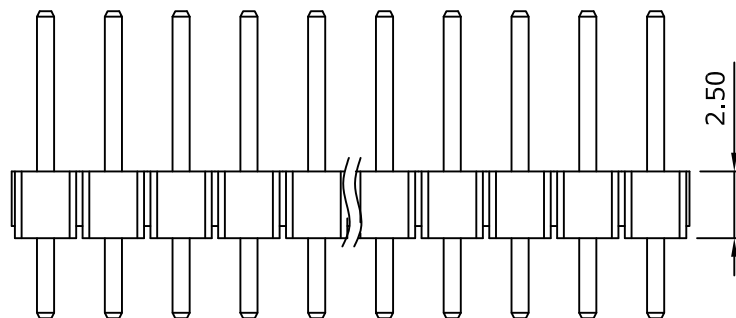
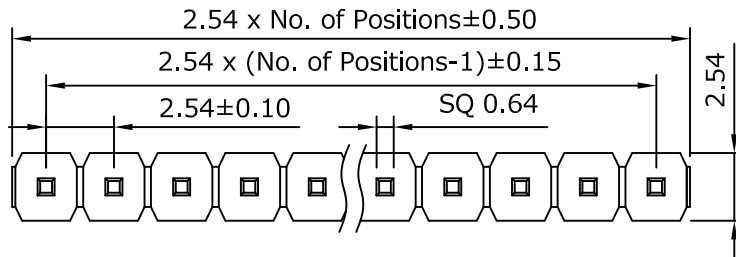
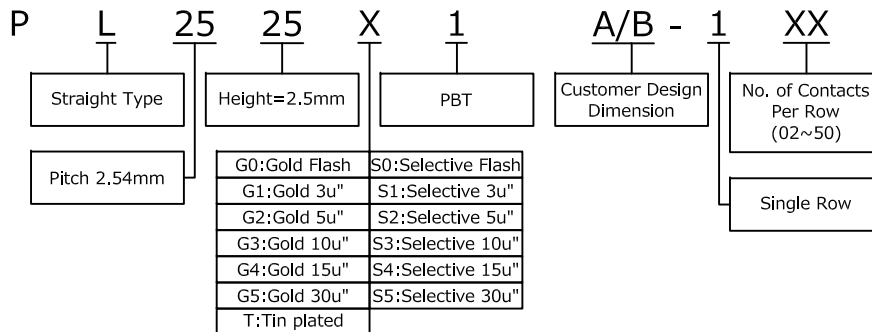

Recommended PCB Layout
 (PCB TOLERANCE ±0.05)

| | | | | | | | | |
|--------|---------------------------|------------------|-----------|-----------------------|-------|-----|------|----|
| | PART NO. | PL2525X1 A/B-1XX | DRAWN | Andrew | | | | |
| | DRAWING NO. | PL2525X1 A/B-1XX | CHECKED | Claudia | | | | |
| | DATE | 2005/05/01 | APPROVED | Brian | | | | |
| TITLE: | Pin Header 2.54mm H=2.5mm | REV. A0 | TOLERANCE | .X ±0.25 .XX ±0.20 | SCALE | 1:1 | UNIT | mm |