

## SRE-260

OUTPUT: APPROX 0.4~4.0W

Metal-Brush motors

代表的用途: 玩具 玩具模型 振动按摩



| MODEL          | VOLTAGE         |               | NO LOAD        |              | AT MAXIMUM EFFICIENCY |              |                |             |              |
|----------------|-----------------|---------------|----------------|--------------|-----------------------|--------------|----------------|-------------|--------------|
|                | OPERATING RANGE | NOMINAL       | SPEED<br>r/min | CURRENT<br>A | SPEED<br>r/min        | CURRENT<br>A | TORQUE<br>g.cm | OUTPUT<br>W | TOGC<br>g.cm |
| SRE-260W-2295  | 1.5~6.0         | 6.0V CONSTANT | 18500          | 0.18         | 15700                 | 0.96         | 21.8           | 3.51        | 14:          |
| SRE-260W-16200 | 1.5~6.0         | 6.0V CONSTANT | 9000           | 0.065        | 7380                  | 0.31         | 15.3           | 1.16        | 85           |
| SRE-260S-16240 | 3.0~9.0         | 4.5V CONSTANT | 4300           | 0.04         | 3566                  | 0.19         | 14.5           | 0.53        | 85           |
| SRE-260S-18130 | 3.0~9.0         | 4.5V CONSTANT | 7500           | 0.08         | 6225                  | 0.39         | 20.4           | 1.30        | 12:          |

### DIRECTION OF ROTATION

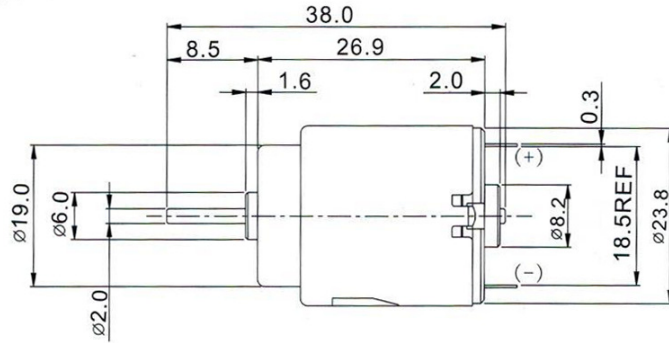
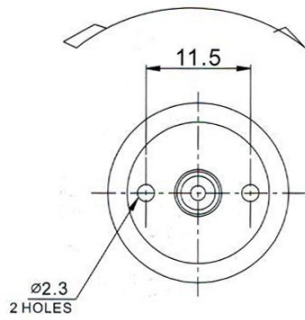

UNIT: MILLIMETER

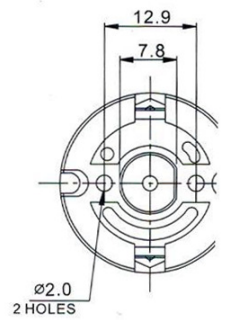

WEIGHT: 28g (APPROX)

SRE-260W-2295

6.0V

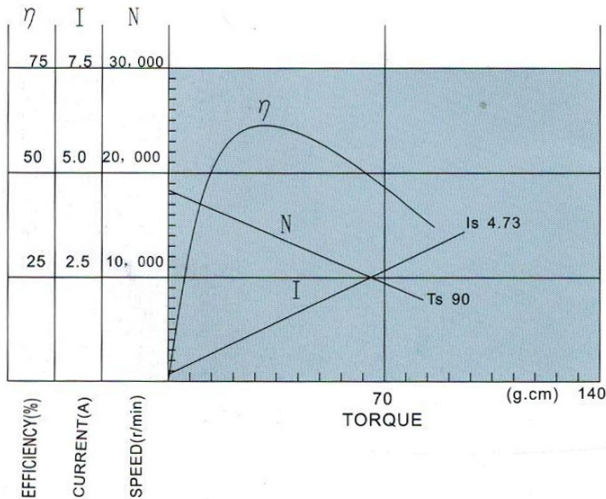

SRE-260S-18130

4.5V

