

SPECIFICATIONS

RATING: 50mA, 12VDC

 ELECTRICAL LIFE: 100,000 cycles (ELTS)
 1,000,000 cycles (ELTS)

Please inquire our office

CONTACT RESISTANCE: 100mΩ max

INSULATION RESISTANCE: 100MΩ min. 500VDC

DIELECTRIC STRENGTH: 250VAC/1 min

OPERATION FORCE: 100gf, 160gf, 260gf, 320gf, 520gf

STORAGE TEMPERATURE: -30°C to +80°C

CONTACT ARRANGEMENT: 1 pole 1 throw

MATERIALS

COVER - Stainless steel or SPCC

BASE - UL94V-0 Nylon Thermoplastic(Black)

STEM - UL94V-0 Nylon Thermoplastic

CONTACT DISC - Phosphor bronze or stainless steel with silver cladding

TERMINAL - Brass with silver cladding

CAP - Thermoplastic ABS

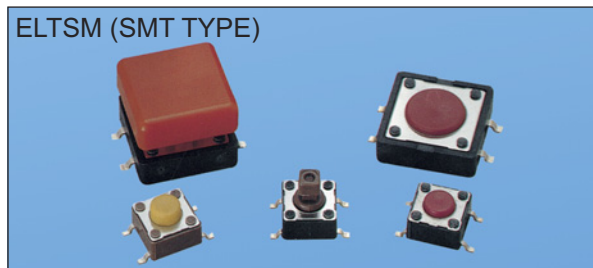
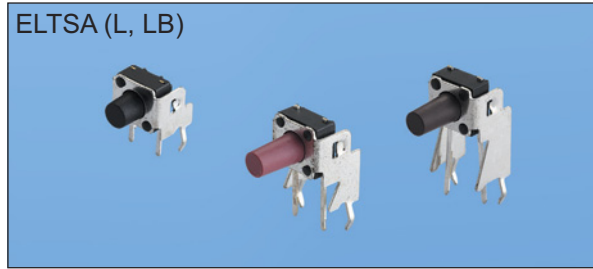
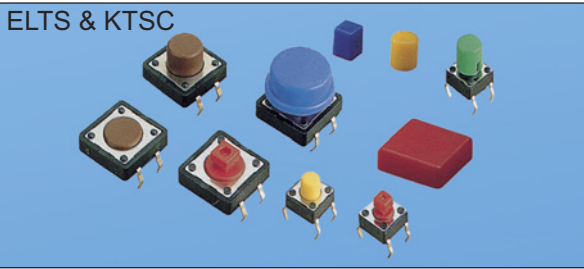
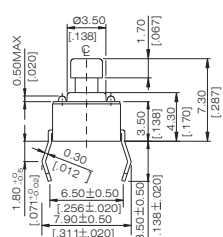
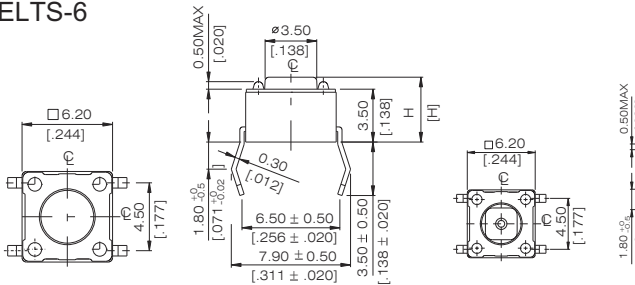

ELTS-6

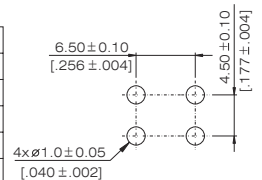
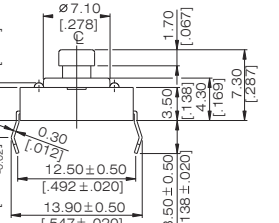
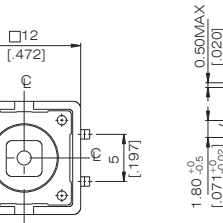
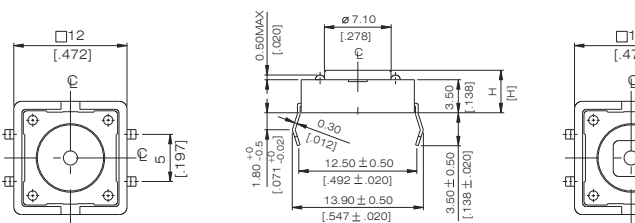
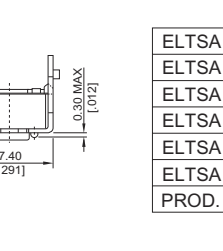
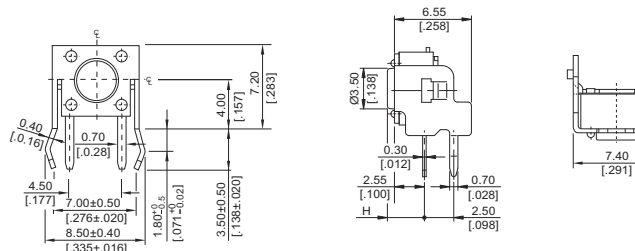
ELTS - 66	□	13.0[.512]
ELTS - 65	□	9.5[.374]
ELTS - 644	□	7.3(SQ)[.287]
ELTS - 63	□	7.0[.275]
ELTS - 62	□	5.0[.197]
ELTS - 61	□	4.3[.169]
PROD. NO.		H

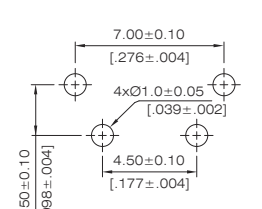

ELTS-2

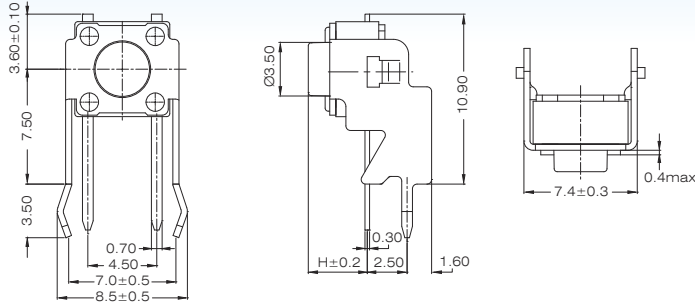
ELTSA-6

ELTSA - 66	□	11.85[.467]
ELTSA - 65	□	8.35[.329]
ELTSA - 644	□	6.15(SQ)[.242]
ELTSA - 63	□	5.85[.230]
ELTSA - 62	□	3.85[.152]
ELTSA - 61	□	3.15[.124]
PROD. NO.		H

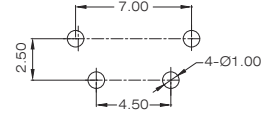
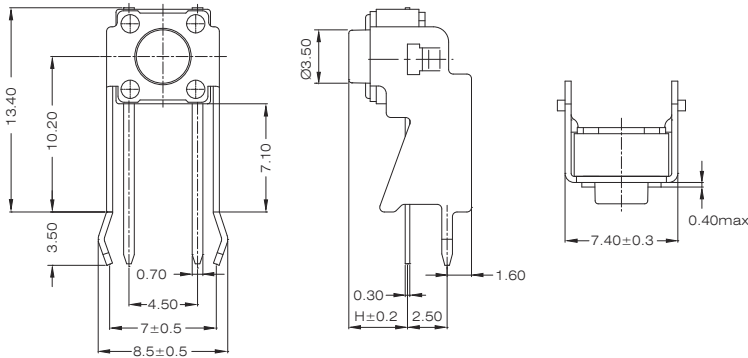

ELTSAL-6

ELTSAL-66	□	11.85[.467]
ELTSAL-65	□	8.35[.329]
ELTSAL-63	□	5.85[.230]
ELTSAL-62	□	3.85[.152]
ELTSAL-61	□	3.15[.124]
PROD.	NO.	H

ELTSALB-6

ELTSALB-66	□	11.85[.467]
ELTSALB-65	□	8.35[.329]
ELTSALB-63	□	5.85[.230]
ELTSALB-62	□	3.85[.152]
ELTSALB-61	□	3.15[.124]
PROD.	NO.	H

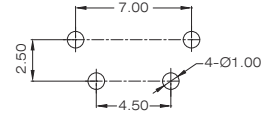
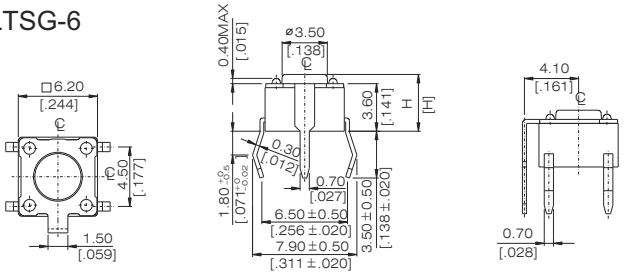
ELTSG-6

ELTSG - 66	□	13.0[.512]
ELTSG - 65	□	9.5[.374]
ELTSG - 644	□	7.3(SQ)[.287]
ELTSG - 63	□	7.0[.275]
ELTSG - 62	□	5.0[.197]
ELTSG - 61	□	4.3[.169]
PROD.	NO.	H

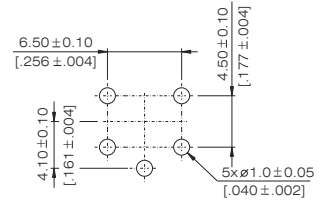
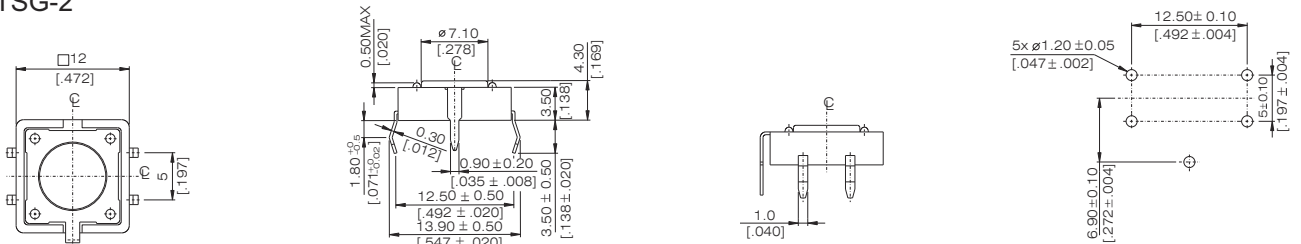
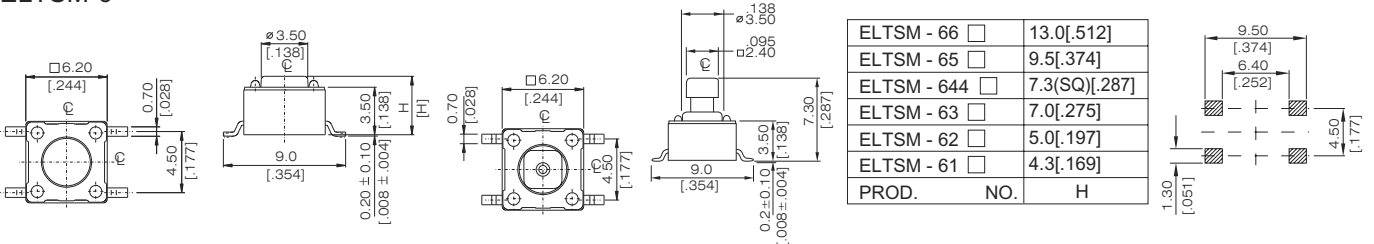
ELTSG-2

ELTSM-6

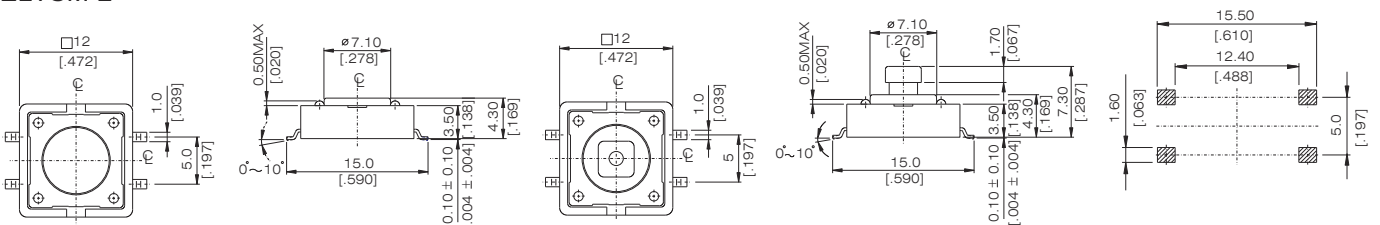
ELTSM - 66	□	13.0[.512]
ELTSM - 65	□	9.5[.374]
ELTSM - 644	□	7.3(SQ)[.287]
ELTSM - 63	□	7.0[.275]
ELTSM - 62	□	5.0[.197]
ELTSM - 61	□	4.3[.169]
PROD.	NO.	H

ELTSM-2



HOW TO ORDER

ELTS □ □ - □ □ □ - □ - □

RoHS code
H= RoHS Compliant

Package Style <Only For ELTSM>:
B= Tube
T/R=Tape & Reel

Operation Force:
▲ K= 100gf N= 160gf
▲ Y= 520gf R= 260gf
 S= 320gf
<▲12x12, K, Y Unavailable>

Dimension H:

CODE		ELTSA-6 ELTSAL-6 ELTSALB-6	ELTS-6 ELTSM-6 ELTSG-6		ELTSG2	ELTS-2 ELTSM-2
▲(SQ.)x2.4mm	1	3.15 mm	4.3 mm	1	4.3 mm	4.3 mm
	2	3.85 mm	5.0 mm			
	3	5.85 mm	7.0 mm	4	7.3 mm	7.3 mm
	44	6.15 mm	7.3 mm		(SQ.) x3.8 mm	(SQ.) x3.8 mm
	5	8.35 mm	9.5 mm			
	6	11.85 mm	13.0 mm	5		8.5mm

*If you need the other height option, please inquire our office

Prod Size:
6= 6.2x6.2 mm
▲2= 12x12 mm
<▲12x12 ELTSA Unavailable>

□ = None Post

□ = Regular Type Tactile Switch
A= Right Angle Type Tactile Switch
G= With Ground Terminal Type Tactile Switch
M= SMT Type Tactile Switch

EL = 100,000 cycles
EH = 1,000,000 cycles (only 6.2x6.2mm, 100gf,
160gf, 260gf, available)

INDEX

TOGGLE

ROCKER

SLIDE

PUSH BUTTON / MICRO

DIP / ROTARY

KEY / TACT